



# PRODUCT CATALOGUE

FOREVER INNOVATION  
FOREVER CARE

## LEPU MEDICAL TECHNOLOGY (BEIJING) CO., LTD

Head Office:  
No.37 Chaoqian Road, Changping  
District, Beijing,  
China, 102200  
Tel: +86-10-80120666  
Fax: +86-10-80120600

International Sales and Marketing:  
Tel: +86-10-80120601  
Fax: +86-10-80123524  
Email: [international@lepu-medical.com](mailto:international@lepu-medical.com)  
Web: [en.lepumedical.com](http://en.lepumedical.com)



## **Company Profile**

Lepu Medical Technology (Beijing) Co., Ltd. was established in 1999. Lepu Medical is specialized in developing, manufacturing and distributing the high-tech medical devices and equipment. Today, Lepu Medical has grown into a global leading group company in the fields of cardiovascular, neurovascular and peripheral vascular interventions, structural heart diseases, surgical cardiology, cardiac rhythm management, anesthesia and critical care, in vitro diagnostics and general surgery with products include coronary stents, dilatation balloon catheters, interventional accessories, occlusion devices, mechanical heart valves, electrophysiology catheters, pacemakers, in vitro diagnostic products, critical care products, angiography systems and surgical staplers. In 2009, Lepu Medical went public in ChiNext Shenzhen Stock Exchange market (stock code: 300003).

Now Lepu Medical totally has 32 primary subsidiary companies worldwide. Currently, there are 123 products have received the CE certificates, and 17 products have got the FDA approvals. As the National Interventional Cardiology Medical Instruments & Engineering Technology Research Center, Lepu Medical Group's top strategy is to build up a 4 in 1 platform includes medical devices, medicines, health services and mobile medicals for cardiac treatments.

Lepu Medical has established three overseas subsidiary companies in Netherland, Turkey and India, obtained local registrations in 27 countries, and built the sales and distribution channels in over 80 countries and regions. Lepu Medical upholds "integrity, quality and scientific innovation" as its spirit, commitments to provide the best quality of products and services to satisfy the needs of healthcare professionals and patients.

*This catalogue includes information of products available in certain countries. Availability of these products may vary with locations. Please contact Lepu Medical for more information about the approval in your region.*

## LEPU MEDICAL

Major Subsidiaries

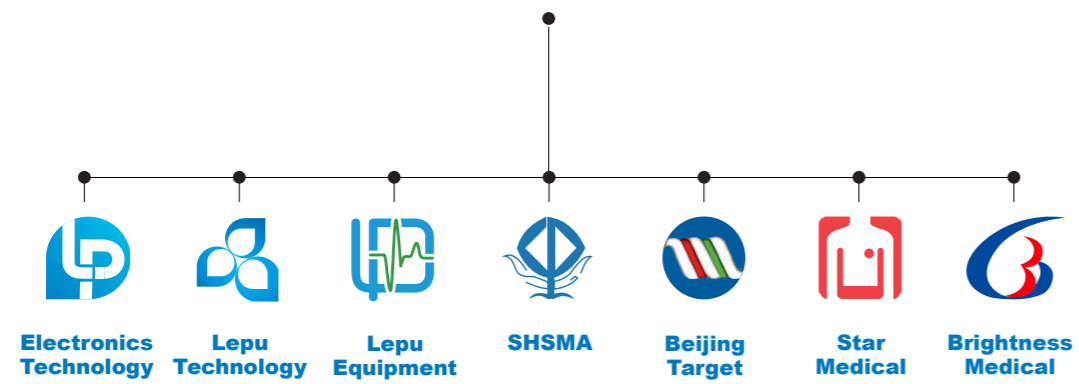

## GLOBAL BUSINESS



The **Global Leading Group Company** in the Fields of  
High-tech Medical Devices and Equipment

- ★ Head Office
- ↗ Overseas Subsidiaries
- Major Markets

# TABLE OF CONTENTS

## 01

### Cardiovascular Interventional Products

#### Coronary Stents

- 07 Nano+™ Polymer-free Sirolimus-eluting Coronary Stent System
- 08 GuReater™ CoCr Sirolimus-eluting Coronary Stent System
- 09 Partner™ Sirolimus-eluting Coronary Stent System CE
- 10 H-Stent™ Coronary Stent System CE

#### PTCA Balloons

- 11 Hoper™ PTCA Balloon Dilatation Catheter CE FDA
- 12 Mini Tadpole™ Coronary Dilatation Catheter CE
- 13 Tadpole™ Coronary Dilatation Catheter CE
- 14 NC Tadpole™ Coronary Dilatation Catheter CE

#### Catheters

- 15 Angiographic Catheter
- 17 Orien™ Guiding Catheter CE
- 19 Thromsweeper™ Thrombus Extraction Catheter
- 20 Deliver™ Infusion Catheter

#### Guide Wires

- 21 Angiographic Guide Wire
- 22 Ultraskin™ Hydrophilic Guide Wire CE FDA
- 23 Balancium Guide Wire CE

#### Introducer Sheaths

- 25 Shoocin™ Introducer Kit CE FDA
- 27 Brilliant™ Introducer Kit CE FDA

#### Accessories

- 29 Rayband™ Radial Artery Compression Tourniquet CE FDA
- 30 Angioway™ Y-Hemostasis Valve Set CE FDA
- 31 Angiopower™ Inflation Device CE FDA
- 32 Inflation Devices Kit CE FDA
- 33 Angioway™ Manifolds CE
- 34 Angioway™ High Pressure Extension Tubings CE
- 35 Introducer Needle CE
- 35 Angiospring™ Angiography Control Syringe CE
- 36 Contrast Medium Injection Manifold Kits CE

## 02

### Neurovascular Interventional Products

#### Vascular Protection

- 39 Disposable Embolic Protection Device CE

#### Embolization

- 40 Embolic Coil System CE

#### Microcatheter

- 41 Disposable Microcatheter CE

#### PTA Balloon

- 43 Supercross™ PTA Balloon Dilatation Catheters CE

## 03

### Peripheral Interventional Products

#### Occlusion Devices

- 47 MemoPart™ Atrial Septal Defect (ASD) Occluder CE
- 49 MemoPart™ Ventricular Septal Defect (VSD) Occluder CE
- 52 MemoPart™ Patent Ductus Arteriosus (PDA) Occluder CE
- 54 MemoPart™ Patent Foramen Ovale (PFO) Occluder CE
- 55 MemoPart™ Plug CE
- 56 MemoPart™ Occluder Delivery System CE
- 58 MemoPart™ Snare CE

#### Mechanical Heart Valves

- 59 GK-3 Single-leaflet Prosthetic Heart Valve
- 60 GKS Bi-leaflet Prosthetic Heart Valve

## 04

### Structural Heart Diseases Products

#### Off-pump Coronary Artery Bypass Grafting

- 62 Disposable Tissue stabilizer

## 05

### Surgical Cardiology Products

# 06

## Cardiac Rhythm Management Products

### Electrophysiology Products

- 65 Eel Cath™ Electrophysiology Diagnostic Catheter CE
- 66 Eel Cath™ Circular Mapping Diagnostic Catheter for Pulmonary Vein CE
- 67 Eel Cath™ Electrophysiology Ablation Catheter CE
- 68 Eel Cath™ Electrophysiology Catheter Cable CE

### Pacemakers and Leads

- 69 Implantable Single Chamber Pacemaker
- 70 Implantable Dual Chamber Pacemaker
- 71 Bipolar Passive Fixation Lead
- 72 Bipolar Active Fixation Lead

### Equipment

- 73 Dual Chamber Pacing System Programmer
- 74 Dual Chamber Pacing System Analyzer

# 07

## Critical Care Products

### IV Catheters

- 77 Safecath™ Disposable Central Venous Catheter Kit CE
- 79 Antimicrobial Central Venous Catheter Kit

### Needle-free Connectors

- 81 Needle-free Connectors CE

### Blood Sampler

- 83 Disposable Arterial Blood Sampler

### Pressure Transducer

- 84 Disposable Blood Pressure Transducer CE

# 08

## In Vitro Diagnostic Products

### IVD Equipment and Biomarkers

- 87 LEPU Quant 800 Colloidal Gold Immunochromatographic Assay Analyzer CE
- 87 Thrombelastography CE
- 88 Biomarkers CE

# 09

## Digital Subtraction Angiography Systems

### Suspended Type

- 91 Vicor-CV300 Digital Subtraction Angiography System

### Floor Type

- 92 Vicor-CV100 Digital Subtraction Angiography System

# 10

## General Surgery Products

### Surgical Staplers

- 95 Staplers CE
- 101 Disposable Skin Stapler and Remover CE
- 101 Disposable Purse String Stapler CE

### Accessories

- 102 Disposable Suction and Irrigation Tube CE
- 102 Disposable Trocar and Veress Needle CE
- 103 Disposable Endoscopic Retrieval Bags CE

# 01

## Cardiovascular Interventional Products

### Coronary Stents

- 07 Nano+™ Polymer-free Sirolimus-eluting Coronary Stent System
- 08 GuReater™ CoCr Sirolimus-eluting Coronary Stent System
- 09 Partner™ Sirolimus-eluting Coronary Stent System **CE**
- 10 H-Stent™ Coronary Stent System **CE**

### PTCA Balloons

- 11 Hoper™ PTCA Balloon Dilatation Catheter **CE FDA**
- 12 Mini Tadpole™ Coronary Dilatation Catheter **CE**
- 13 Tadpole™ Coronary Dilatation Catheter **CE**
- 14 NC Tadpole™ Coronary Dilatation Catheter **CE**

### Catheters

- 15 Angiographic Catheter
- 17 Orien™ Guiding Catheter **CE**
- 19 Thromsweeper™ Thrombus Extraction Catheter
- 20 Deliver™ Infusion Catheter

### Guide Wires

- 21 Angiographic Guide Wire
- 22 Ultraskin™ Hydrophilic Guide Wire **CE FDA**
- 23 Balancium Guide Wire **CE**

### Introducer Sheaths

- 25 Shoocin™ Introducer Kit **CE FDA**
- 27 Brilliant™ Introducer Kit **CE FDA**

### Accessories

- 29 Rayband™ Radial Artery Compression Tourniquet **CE FDA**
- 30 Angiway™ Y-Hemostasis Valve Set **CE FDA**
- 31 Angiopower™ Inflation Device **CE FDA**
- 32 Inflation Devices Kit **CE FDA**
- 33 Angiway™ Manifolds **CE**
- 34 Angiway™ High Pressure Extension Tubings **CE**
- 35 Introducer Needle **CE**
- 35 Angiospring™ Angiography Control Syringe **CE**
- 36 Contrast Medium Injection Manifold Kits **CE**

## Nano+™

### Polymer-free Sirolimus-eluting Coronary Stent System

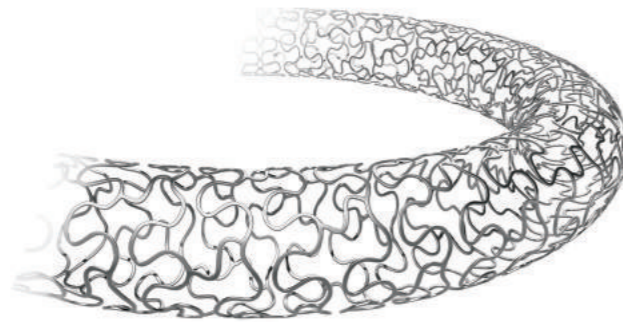

#### The efficacy of DES

- Nanoporous cavities on strut abluminal surface functioning as drug carrier to ensure the firm adhesion.
- Post-treatment after drug loading helps with sustained drug release.
- Scientific drug releasing period effectively inhibits SMC migration and proliferation.

#### The safety of BMS

- Polymer-free design significantly reduces the inflammatory response after stent implantation compare to polymer coating stent, which guarantees the long-term safety.
- Polymer-free design facilitates earlier endothelialization which shorten the DAPT time.
- The rough strut surface helps with easier and faster endothelialization to reduce the risk of thrombosis.

#### New delivery system

- Soft tapered tip provides smooth transition from guidewire to balloon catheter and excellent crossability.
- Short shoulder design at both ends of the balloon reduces the damage to normal vessel next to the lesion.
- Patented hydrophilic coating on distal shaft provides outstanding pushability.

#### Technical Parameters

Stent Material	316L Stainless Steel
Strut Design	Open cell
Metal to Artery Ratio	15%
Recoil	< 2%
Shortening	< 1%
Crossing Profile	0.035" (0.90mm)

#### Ordering Information

Stent Diameter (mm)	Stent Length (mm)						
	12	15	18	21	24	29	36
2.5	LPRPS2512	LPRPS2515	LPRPS2518	LPRPS2521	LPRPS2524	LPRPS2529	LPRPS2536
2.75	LPRPS2712	LPRPS2715	LPRPS2718	LPRPS2721	LPRPS2724	LPRPS2729	LPRPS2736
3.0	LPRPS3012	LPRPS3015	LPRPS3018	LPRPS3021	LPRPS3024	LPRPS3029	LPRPS3036
3.5	LPRPS3512	LPRPS3515	LPRPS3518	LPRPS3521	LPRPS3524	LPRPS3529	LPRPS3536
4.0	LPRPS4012	LPRPS4015	LPRPS4018	LPRPS4021	LPRPS4024	LPRPS4029	LPRPS4036

## GuReater™

### CoCr Sirolimus-eluting Coronary Stent System



- 75 µm ultrathin strut thickness and unique strut structure guarantee the excellent compliance of the stent during delivery.
- PLGA biodegradable polymer coating provides precise drug releasing control and scientific degradation period.
- CoCr stent has great radiopacity, biocompatibility, and provides excellent balance between radial strength and flexibility.
- MRI compatible

#### Technical Parameters

Stent Material	L605 CoCr Alloy
Strut Design	Open cell
Metal to Artery Ratio	15%
Recoil	3.4%
Shortening	< 1%
Crossing Profile	0.035" (0.90mm)

#### Ordering Information

Stent Diameter (mm)	Stent Length (mm)							
	12	15	18	21	24	29	33	36
2.5	LPRPC 2512	LPRPC 2515	LPRPC 2518	LPRPC 2521	LPRPC 2524	LPRPC 2529	/	/
2.75	LPRPC 2712	LPRPC 2715	LPRPC 2718	LPRPC 2721	LPRPC 2724	LPRPC 2729	/	/
3.0	LPRPC 3012	LPRPC 3015	LPRPC 3018	LPRPC 3021	LPRPC 3024	LPRPC 3029	LPRPC 3033	LPRPC 3036
3.5	LPRPC 3512	LPRPC 3515	LPRPC 3518	LPRPC 3521	LPRPC 3524	LPRPC 3529	LPRPC 3533	LPRPC 3536
4.0	LPRPC 4012	LPRPC 4015	LPRPC 4018	LPRPC 4021	LPRPC 4024	LPRPC 4029	LPRPC 4033	LPRPC 4036

Notice: Please contact the sales for detailed information before placing the order.

## Partner™ Sirolimus-eluting Coronary Stent System

CE



- PBMA/PEVA double layer polymer coating provides optimal drug releasing control.
- Scientific drug releasing period effectively inhibits SMC migration and proliferation.
- The thickness of polymer coating is only 6µm, which ensures the good deliverability.
- Optimal strut thickness provides favorable balance between radial strength and easier endothelialization.
- Large open cell design allows of excellent side branch access.

### Technical Parameters

Stent Material	316L Stainless Steel
Strut Design	Open cell
Metal to Artery Ratio	15%
Recoil	< 2%
Shortening	< 1%
Crossing Profile	0.90mm (0.035")

### Ordering Information

Stent Diameter (mm)	Stent Length (mm)							
	12	15	18	21	24	29	33	36
2.5	LPRP 2512	LPRP 2515	LPRP 2518	LPRP 2521	LPRP 2524	LPRP 2529	LPRP 2533	LPRP 2536
2.75	LPRP 2712	LPRP 2715	LPRP 2718	LPRP 2721	LPRP 2724	LPRP 2729	LPRP 2733	LPRP 2736
3.0	LPRP 3012	LPRP 3015	LPRP 3018	LPRP 3021	LPRP 3024	LPRP 3029	LPRP 3033	LPRP 3036
3.5	LPRP 3512	LPRP 3515	LPRP 3518	LPRP 3521	LPRP 3524	LPRP 3529	LPRP 3533	LPRP 3536
4.0	LPRP 4012	LPRP 4015	LPRP 4018	LPRP 4021	LPRP 4024	LPRP 4029	LPRP 4033	LPRP 4036

## H-Stent™ Coronary Stent System

CE



- Optimal strut thickness provides favorable balance between radial strength and deliverability.
- Patented double-helix structure design ensures outstanding flexibility and compliance.
- Large open cell design allows of excellent side branch access.

### Technical Parameters

Stent Material	316L Stainless Steel
Strut Design	Open cell
Metal to Artery Ratio	15%-18%
Recoil	< 2%
Shortening	< 1%
Strut Thickness	85µm (0.0033")
Crossing Profile	0.90mm (0.035")

### Ordering Information

Stent Diameter (mm)	Stent Length (mm)													
	9	12	14*	15*	16	18*	20	21*	22*	24	27*	29	33*	36*
2.5	LPCSRX 2509	LPCSRX 2512	LPCSRX 2514	LPCSRX 2515	LPCSRX 2516	LPCSRX 2518	LPCSRX 2520	LPCSRX 2521	LPCSRX 2522	LPCSRX 2524	LPCSRX 2527	LPCSRX 2529	LPCSRX 2533	LPCSRX 2536
2.75	LPCSRX 2709	LPCSRX 2712	LPCSRX 2714	LPCSRX 2715	LPCSRX 2716	LPCSRX 2718	LPCSRX 2720	LPCSRX 2721	LPCSRX 2722	LPCSRX 2724	LPCSRX 2727	LPCSRX 2729	LPCSRX 2733	LPCSRX 2736
3.0	LPCSRX 3009	LPCSRX 3012	LPCSRX 3014	LPCSRX 3015	LPCSRX 3016	LPCSRX 3018	LPCSRX 3020	LPCSRX 3021	LPCSRX 3022	LPCSRX 3024	LPCSRX 3027	LPCSRX 3029	LPCSRX 3033	LPCSRX 3036
3.5	/	LPCSRX 3512	LPCSRX 3514	LPCSRX 3515	LPCSRX 3516	LPCSRX 3518	LPCSRX 3520	LPCSRX 3521	LPCSRX 3522	LPCSRX 3524	LPCSRX 3527	LPCSRX 3529	LPCSRX 3533	LPCSRX 3536
4.0	/	LPCSRX 4012	LPCSRX 4014	LPCSRX 4015	LPCSRX 4016	LPCSRX 4018	LPCSRX 4020	LPCSRX 4021	LPCSRX 4022	LPCSRX 4024	LPCSRX 4027	LPCSRX 4029	LPCSRX 4033	LPCSRX 4036

Notice: The sizes with \*mark require a minimum quantity of 10 pcs per order. Please contact the sales for detailed information before placing the order.



## Hoper™

### PTCA Balloon Dilatation Catheter

CE FDA



- Small tip profile for excellent crossability.
- Three-directional memory folding of the balloon allows of size minimization with great withdrawal capability, and ensures the good performance of repeated dilatation.
- Soft tapered tip provides smooth transition from guidewire to balloon catheter to avoid “fish mouth”, and minimize the vessel damage.
- Transparent hub is convenient to observe the air bubble to reduce the operation risk.

#### Technical Parameters

Material	Nylon
Catheter Design	Rapid Exchange
Balloon Compliance	Semi-compliant
Marker	2
Distal Shaft O.D.	2.8F
Proximal Shaft O.D.	2.3F
Tip Profile	0.017"
Minimum Guiding Catheter Compatibility	5F (0.056")
Guide Wire Compatibility	0.014"
Effective Length	135cm
Nominal Pressure	8 atm (φ1.5mm-3.0mm) / 6 atm (φ3.5mm-4.0mm)
Rated Burst Pressure	16 atm (φ1.5mm-3.5mm) / 14 atm (φ4.0mm)

#### Ordering Information

Balloon Diameter (mm)	Balloon Length (mm)										
	9	11*	12	14*	16	18	20	22*	24	26*	30
1.5	LPRX 15009	LPRX 15011	LPRX 15012	LPRX 15014	LPRX 15016	LPRX 15018	LPRX 15020	LPRX 15022	LPRX 15024	LPRX 15026	LPRX 15030
1.75	LPRX 17009	LPRX 17011	LPRX 17012	LPRX 17014	LPRX 17016	LPRX 17018	LPRX 17020	LPRX 17022	LPRX 17024	LPRX 17026	LPRX 17030
2.0	LPRX 20009	LPRX 20011	LPRX 20012	LPRX 20014	LPRX 20016	LPRX 20018	LPRX 20020	LPRX 20022	LPRX 20024	LPRX 20026	LPRX 20030
2.5	LPRX 25009	LPRX 25011	LPRX 25012	LPRX 25014	LPRX 25016	LPRX 25018	LPRX 25020	LPRX 25022	LPRX 25024	LPRX 25026	LPRX 25030
2.75	LPRX 27009	LPRX 27011	LPRX 27012	LPRX 27014	LPRX 27016	LPRX 27018	LPRX 27020	LPRX 27022	LPRX 27024	LPRX 27026	LPRX 27030
3.0	LPRX 30009	LPRX 30011	LPRX 30012	LPRX 30014	LPRX 30016	LPRX 30018	LPRX 30020	LPRX 30022	LPRX 30024	LPRX 30026	LPRX 30030
3.5	LPRX 35009	LPRX 35011	LPRX 35012	LPRX 35014	LPRX 35016	LPRX 35018	LPRX 35020	LPRX 35022	LPRX 35024	LPRX 35026	LPRX 35030
4.0	LPRX 40009	LPRX 40011	LPRX 40012	LPRX 40014	LPRX 40016	LPRX 40018	LPRX 40020	LPRX 40022	LPRX 40024	LPRX 40026	LPRX 40030

Notice: The sizes with \* mark require a minimum quantity of 10 pcs per order. Please contact the sales for detailed information before placing the order.

## Mini Tadpole™

### Coronary Dilatation Catheter

CE



- Small tip and crossing profiles ensure the better performance for CTO lesions.
- Capable for kissing balloon under 6F guiding catheter.
- Patented hydrophilic coating on distal shaft and Hypotube proximal shaft provide outstanding deliverability.
- Three-directional memory folding of the balloon allows of size minimization with great withdrawal capability, and ensures the good performance of repeated dilatation.
- Soft tapered tip provides smooth transition from guidewire to balloon catheter to avoid “fish mouth”, and minimize the vessel damage.
- Short shoulder design at both ends of the balloon ensures the precise dilatation, and reduces the damage to normal vessel next to the lesion.

#### Technical Parameters

Material	Pebax
Catheter Design	Rapid Exchange
Balloon Compliance	Semi-compliant
Marker	2
Distal Shaft O.D.	2.6F
Proximal Shaft O.D.	1.9F
Tip Profile	0.017"
Minimum Guiding Catheter Compatibility	5F (0.056")
Guide Wire Compatibility	0.014"
Effective Length	142cm
Nominal Pressure	8 atm
Rated Burst Pressure	16 atm

#### Ordering Information

Balloon Diameter (mm)	Balloon Length (mm)						
	8	10	12	15	20	25	30
1.2*	LPMRX 12008	LPMRX 12010	LPMRX 12012	LPMRX 12015	LPMRX 12020	/	/
1.5	LPMRX 15008	LPMRX 15010	LPMRX 15012	LPMRX 15015	LPMRX 15020	LPMRX 15025	/
1.75	LPMRX 17008	LPMRX 17010	LPMRX 17012	LPMRX 17015	LPMRX 17020	LPMRX 17025	LPMRX 17030
2.0	LPMRX 20008	LPMRX 20010	LPMRX 20012	LPMRX 20015	LPMRX 20020	LPMRX 20025	LPMRX 20030

\* Notice: NOT AVAILABLE NOW.  
Please contact the sales for detailed information before placing the order.

## Tadpole™

### Coronary Dilatation Catheter

CE



- Outstanding performance for kissing balloon under 6F guiding catheter.
- Patented hydrophilic coating on distal shaft and Hypotube proximal shaft provide outstanding deliverability.
- Three-directional memory folding of the balloon allows of size minimization with great withdrawal capability, and ensures the good performance of repeated dilatation.
- Soft tapered tip provides smooth transition from guidewire to balloon catheter to avoid “fish mouth”, and minimize the vessel damage.
- Short shoulder design at both ends of the balloon ensures the precise dilatation, and reduces the damage to normal vessel next to the lesion.

#### Technical Parameters

Material	Pebax
Catheter Design	Rapid Exchange
Balloon Compliance	Semi-compliant
Marker	2
Distal Shaft O.D.	2.6F
Proximal Shaft O.D.	1.9F
Tip Profile	0.017"
Minimum Guiding Catheter Compatibility	5F (0.056")
Guide Wire Compatibility	0.014"
Effective Length	142cm
Nominal Pressure	8 atm (φ2.25mm-3.0mm) / 6 atm (φ3.5mm-4.0mm)
Rated Burst Pressure	16 atm (φ2.25mm-3.5mm) / 14 atm (φ4.0mm)

#### Ordering Information

Balloon Diameter (mm)	Balloon Length (mm)						
	8	10	12	15	20	25	30
2.25*	LPCR	LPCR	LPCR	LPCR	LPCR	LPCR	LPCR
	22008	22010	22012	22015	22020	22025	22030
2.5	LPCR	LPCR	LPCR	LPCR	LPCR	LPCR	LPCR
	25008	25010	25012	25015	25020	25025	25030
2.75	LPCR	LPCR	LPCR	LPCR	LPCR	LPCR	LPCR
	27008	27010	27012	27015	27020	27025	27030
3.0	LPCR	LPCR	LPCR	LPCR	LPCR	LPCR	LPCR
	30008	30010	30012	30015	30020	30025	30030
3.5	LPCR	LPCR	LPCR	LPCR	LPCR	LPCR	LPCR
	35008	35010	35012	35015	35020	35025	35030
4.0	LPCR	LPCR	LPCR	LPCR	LPCR	LPCR	LPCR
	40008	40010	40012	40015	40020	40025	40030

\* Notice: NOT AVAILABLE NOW.  
Please contact the sales for detailed information before placing the order.

## NC Tadpole™

### Coronary Dilatation Catheter

CE

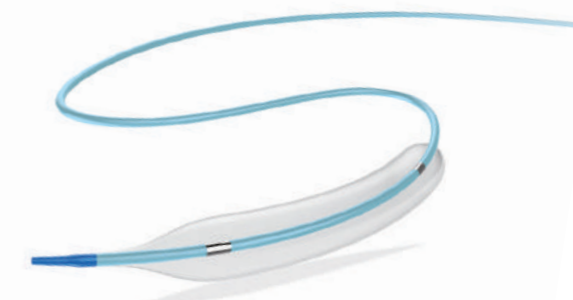

- Strong radial strength with high RBP (22 atm) contributes to excellent stent apposition for post-dilatation.
- Patented hydrophilic coating on distal shaft provides outstanding deliverability.
- Three-directional memory folding of the balloon allows of size minimization with great withdrawal capability, and ensures the good performance of repeated dilatation.
- Soft tapered tip provides smooth transition from guidewire to balloon catheter to avoid “fish mouth”, and minimize the vessel damage.
- Short shoulder design at both ends of the balloon ensures the precise dilatation, and reduces the damage to normal vessel next to the lesion.

#### Technical Parameters

Material	Nylon
Catheter Design	Rapid Exchange
Balloon Compliance	Non-compliant
Marker	2
Distal Shaft O.D.	2.7F
Proximal Shaft O.D.	2.3F
Tip Profile	0.018"
Minimum Guiding Catheter Compatibility	5F (0.056")
Guide Wire Compatibility	0.014"
Effective Length	135cm
Nominal Pressure	14 atm
Rated Burst Pressure	22 atm

#### Ordering Information

Balloon Diameter (mm)	Balloon Length (mm)							
	6	8	10	12	15	20	25	30
1.5	LPNRX15006	LPNRX15008	LPNRX15010	LPNRX15012	LPNRX15015	LPNRX15020	LPNRX15025*	LPNRX15030*
	2.0	LPNRX20006	LPNRX20008	LPNRX20010	LPNRX20012	LPNRX20015	LPNRX20020	LPNRX20025
2.25	LPNRX22006	LPNRX22008	LPNRX22010	LPNRX22012	LPNRX22015	LPNRX22020	LPNRX22025	LPNRX22030
	2.5	LPNRX25006	LPNRX25008	LPNRX25010	LPNRX25012	LPNRX25015	LPNRX25020	LPNRX25025
2.75	LPNRX27006	LPNRX27008	LPNRX27010	LPNRX27012	LPNRX27015	LPNRX27020	LPNRX27025	LPNRX27030
	3.0	LPNRX30006	LPNRX30008	LPNRX30010	LPNRX30012	LPNRX30015	LPNRX30020	LPNRX30025
3.25	LPNRX32006	LPNRX32008	LPNRX32010	LPNRX32012	LPNRX32015	LPNRX32020	LPNRX32025	LPNRX32030
	3.5	LPNRX35006	LPNRX35008	LPNRX35010	LPNRX35012	LPNRX35015	LPNRX35020	LPNRX35025
3.75	LPNRX37006	LPNRX37008	LPNRX37010	LPNRX37012	LPNRX37015	LPNRX37020	LPNRX37025	LPNRX37030
	4.0	LPNRX40006	LPNRX40008	LPNRX40010	LPNRX40012	LPNRX40015	LPNRX40020	LPNRX40025
4.5	LPNRX45006*	LPNRX45008	LPNRX45010	LPNRX45012	LPNRX45015	LPNRX45020	LPNRX45025*	LPNRX45030*

\* Notice: Please contact the sales for detailed information before placing the order.

## Angiographic Catheter

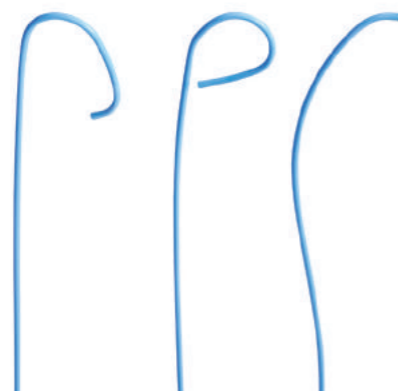

- Smooth external wall provides great crossability through tortuous vasculature.
- PTFE internal wall provides smooth lumen to ensure the excellent trackability.
- The middle layer of braided stainless steel mesh guarantees outstanding torque transmission and kink resistance.
- Large lumen diameter allows of high flow rate of contrast agent.

### Ordering Information\*

Catalogue No.	Outer Diameter	Effective Length (cm)	Hole Count (ea)	Distal Shape
LPS00040100	4F	100	0	Straight
LPS00050100	5F	100	0	Straight
LPS00060100	6F	100	0	Straight
LPJL35040100	4F	100	0	JL3.5
LPJL40040100	4F	100	0	JL4.0
LPJL45040100	4F	100	0	JL4.5
LPJL50040100	4F	100	0	JL5.0
LPJL60040100	4F	100	0	JL6.0
LPJL35050100	5F	100	0	JL3.5
LPJL40050100	5F	100	0	JL4.0
LPJL45050100	5F	100	0	JL4.5
LPJL50050100	5F	100	0	JL5.0
LPJL60050100	5F	100	0	JL6.0
LPJL35060100	6F	100	0	JL3.5
LPJL40060100	6F	100	0	JL4.0
LPJL45060100	6F	100	0	JL4.5
LPJL50060100	6F	100	0	JL5.0
LPJL60060100	6F	100	0	JL6.0
LPJR35040100	4F	100	0	JR3.5
LPJR40040100	4F	100	0	JR4.0
LPJR50040100	4F	100	0	JR5.0
LPJR60040100	4F	100	0	JR6.0
LPJR35050100	5F	100	0	JR3.5
LPJR40050100	5F	100	0	JR4.0
LPJR50050100	5F	100	0	JR5.0
LPJR60050100	5F	100	0	JR6.0
LPJR35060100	6F	100	0	JR3.5
LPJR40060100	6F	100	0	JR4.0
LPJR40060125	6F	125	0	JR4.0
LPJR50060100	6F	100	0	JR5.0
LPJR60060100	6F	100	0	JR6.0

Catalogue No.	Outer Diameter	Effective Length (cm)	Hole Count (ea)	Distal Shape
LPP80640110	4F	110	6	PIG-80
LPP45640110	4F	110	6	PIG-145
LPP55640110	4F	110	6	PIG-155
LPP80650110	5F	110	6	PIG-80
LPP45650110	5F	110	6	PIG-145
LPP55650110	5F	110	6	PIG-155
LPP80660110	6F	110	6	PIG-80
LPP45660110	6F	110	6	PIG-145
LPP55660110	6F	110	6	PIG-155
LPAL10040100	4F	100	0	AL1.0
LPAL20040100	4F	100	0	AL2.0
LPAL30040100	4F	100	0	AL3.0
LPAL10050100	5F	100	0	AL1.0
LPAL20050100	5F	100	0	AL2.0
LPAL30050100	5F	100	0	AL3.0
LPAL10060100	6F	100	0	AL1.0
LPAL20060100	6F	100	0	AL2.0
LPAL30060100	6F	100	0	AL3.0
LPAR10040100	4F	100	0	AR1.0
LPAR20040100	4F	100	0	AR2.0
LPAR30040100	4F	100	0	AR3.0
LPAR10050100	5F	100	0	AR1.0
LPAR20050100	5F	100	0	AR2.0
LPAR30050100	5F	100	0	AR3.0
LPAR10060100	6F	100	0	AR1.0
LPAR20060100	6F	100	0	AR2.0
LPAR30060100	6F	100	0	AR3.0
LPRCB00040100	4F	100	0	RCB
LPRCB00050100	5F	100	0	RCB
LPRCB00060100	6F	100	0	RCB
LPLCB00040100	4F	100	0	LCB
LPLCB00050100	5F	100	0	LCB
LPLCB00060100	6F	100	0	LCB
LPIM00040100	4F	100	0	IM
LPIM00050100	5F	100	0	IM
LPIM00060100	6F	100	0	IM
LPC00040100	4F	100	0	TIG
LPC00050100	5F	100	0	TIG
LPC00060100	6F	100	0	TIG



\* Notice: Please contact the sales for detailed information before placing the order.

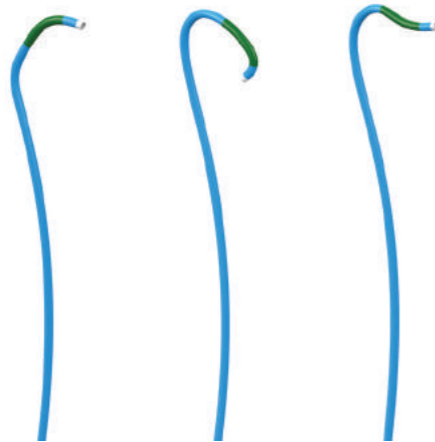

**Orien™**  
Guiding Catheter  
CE



- Flat wire braided middle layer offers outstanding flexibility and excellent kink resistance.
- 1:1 torque for easy operation and accurate placement.
- Robust secondary curve provides great backup support and curve retention.
- Soft and flexible tip minimize the damage to the vessel wall.
- PTFE internal wall provides smooth lumen to ensure the excellent trackability.
- Large lumen guarantees the good performance for kissing balloon.

**Ordering Information**

Right Coronary Curves						
Curve Type	Catalogue No.	Distal End Shape	Catheter O.D.	Catheter I.D.	Length (cm)	
Judkins Right	CL5JR35	JR 3.5	5F	0.056"	100	
	CL5JR40	JR 4.0				
	CL5JR45	JR 4.5				
	CL5JR50	JR 5.0	6F	0.071"		
	CL6JR35	JR 3.5				
	CL6JR40	JR 4.0				
	CL6JR45	JR 4.5	7F	0.078"		
	CL6JR50	JR 5.0				
	CL7JR35	JR 3.5				
Amplatz Right	CL5AR10	AR 1.0	5F	0.056"	100	
	CL5AR20	AR 2.0	6F	0.071"		
	CL6AR10	AR 1.0				
	CL6AR20	AR 2.0	7F	0.078"		
	CL7AR10	AR 1.0				
	CL7AR20	AR 2.0				

Left Coronary Curves						
Curve Type	Catalogue No.	Distal End Shape	Catheter O.D.	Catheter I.D.	Length (cm)	
Judkins Left	CL5JL35	JL 3.5	5F	0.056"	100	
	CL5JL40	JL 4.0				
	CL5JL45*	JL 4.5				
	CL5JL50*	JL 5.0	6F	0.071"		
	CL6JL35	JL 3.5				
	CL6JL40	JL 4.0				
	CL6JL45*	JL 4.5	7F	0.078"		
	CL6JL50*	JL 5.0				
	CL7JL35	JL 3.5				
Amplatz Left	CL5AL10	AL 1.0	5F	0.056"	100	
	CL5AL20	AL 2.0	6F	0.071"		
	CL6AL075	AL 0.75				
	CL6AL10	AL 1.0	7F	0.078"		
	CL6AL20	AL 2.0				
	CL7AL075	AL 0.75				
	Extra Backup	CL5XB30	XB 3.0	5F		
CL5XB35		XB 3.5				
CL5XB40		XB 4.0				
CL6XB30		XB 3.0	6F	0.071"		
CL6XB35		XB 3.5				
CL6XB40		XB 4.0				
CL6XBC35		XBC 3.5	7F	0.078"		
CL6XBLAD35		XBLAD 3.5				
CL7XB30		XB 3.0				
CL7XB35		XB 3.5	7F	0.078"		
CL7XB40		XB 4.0				
CL7XBLAD35		XBLAD 3.5				

\* Notice: Please contact the sales for detailed information before placing the order. More CE and OEM distal shapes are available. Guiding catheter with hydrophilic coating is available.

## Thromsweeper™

### Thrombus Extraction Catheter

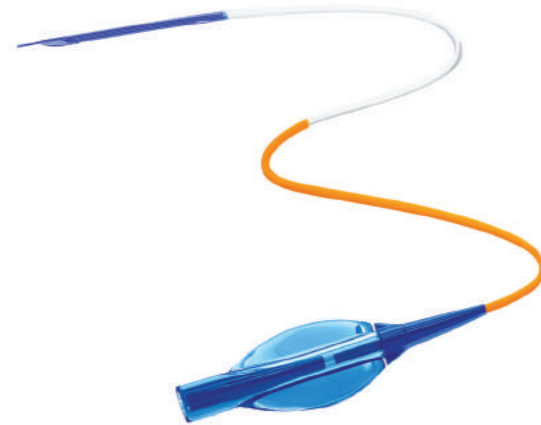

- Large suction lumen minimizes the flow resistance and boosts the extraction performance.
- Low crossing profile is designed for the compatibility with the smallest 6F guiding catheter.
- Hydrophilic coating on distal shaft provides great crossability and deliverability.
- Embedded Platinum marker empowers smooth-feeling of delivery and visualization.
- Removable support-wire helps rapidly and easily reach to the lesion.

#### Technical Parameters

Design	Rapid Exchange	
Guiding Catheter Compatibility (minimum)	6F (0.070")	
Guide Wire Compatibility	0.014"	
Effective Length	1450mm	
Extraction Lumen Area	1.03mm <sup>2</sup>	
Guide wire Lumen Length	113mm	
Catheter O.D.	Proximal	1.27mm
	Distal	1.50mm

#### Ordering Information

Catalogue No.	Specification
XS500001	150

Notice: Please contact the sales for detailed information before placing the order.

## Deliver™

### Infusion Catheter



- Combined liquid perfusion lumen and guide wire lumen fulfills the perfusion to target lesion without withdrawing the guide wire.
- Rapid exchange design, convenient for operation.
- Pt-Ir marker provides excellent visibility under X-ray.

#### Technical Parameters

Material	Stainless steel filmed with Nylon
Marker	Pt-Ir Alloy
Tip O.D.	1.5F (0.50mm)
Distal O.D.	3.3F (1.09mm)
Proximal O.D.	3.1F (1.03mm)
Guide Wire Lumen I.D.	0.015" (0.38mm)
Effective Length	1390mm
Guiding Catheter Compatibility	5F/ 6F/ 7F
Guide Wire Compatibility	0.014"

#### Ordering Information

Catalogue No.	Specification
LPRX139	

Notice: Please contact the sales for detailed information before placing the order.

## Angiographic Guide Wire



- Stainless steel core wire offers excellent torque transmission and kink resistance.
- Over-the-wire coil offers outstanding deliverability and radiopacity.

### Ordering Information

Catalogue No.	Tip Shape	Outer Diameter	Length (cm)	Type
MMNSF35150	Straight	0.035"	150	Teflon coating, coiled
MMNSF35260	Straight	0.035"	260	Teflon coating, coiled
MMNJF35150	J	0.035"	150	Teflon coating, coiled
MMNJF35260	J	0.035"	260	Teflon coating, coiled
MMNSF38150	Straight	0.038"	150	Teflon coating, coiled
MMNSF38260	Straight	0.038"	260	Teflon coating, coiled
MMNJF38150	J	0.038"	150	Teflon coating, coiled
MMNJF38260	J	0.038"	260	Teflon coating, coiled

Notice: Please contact the sales for detailed information before placing the order.

## Ultraskin™ Hydrophilic Guide Wire

CE FDA



- Nitinol core wire guarantees great tip shape retention, outstanding kink resistance and 1:1 torque control.
- PU Jacket incorporated with tungsten provides highly radiopacity.
- Super smooth hydrophilic coating reduces friction, and provides excellent navigation in and out the catheter.
- Soft tapered tip increases distal flexibility, contributes to smooth vessel insertion, and minimizes the risk of trauma.

### Ordering Information

Catalogue No.	Outer Diameter	Guide Wire Length (cm)	Distal Curve	Note
SD-S18150	0.018"	150	Straight	Standard
SD-A18150	0.018"	150	135° Angled	Standard
SD-S32150	0.032"	150	Straight	Standard
SD-A32150	0.032"	150	135° Angled	Standard
SD-S32180	0.032"	180	Straight	Standard
SD-A32180	0.032"	180	135° Angled	Standard
SD-S32260	0.032"	260	Straight	Standard
SD-A32260	0.032"	260	135° Angled	Standard
SD-S35150	0.035"	150	Straight	Standard
SD-A35150	0.035"	150	135° Angled	Standard
SD-S35180	0.035"	180	Straight	Standard
SD-A35180	0.035"	180	135° Angled	Standard
SD-S35260	0.035"	260	Straight	Standard
SD-A35260	0.035"	260	135° Angled	Standard
SP-S35150	0.035"	150	Straight	Reshapable Tip
SP-A35150	0.035"	150	135° Angled	Reshapable Tip
SP-S35180	0.035"	180	Straight	Reshapable Tip
SP-A35180	0.035"	180	135° Angled	Reshapable Tip
ST-S35150	0.035"	150	Straight	Stiff Shaft
ST-A35150	0.035"	150	135° Angled	Stiff Shaft

# Balancium

## Guide Wire



### Two Types of Core Design for Different Clinical Needs

- **Core-to-Tip** design provides great tip stiffness, good touch feedback and moderate support for easy control and better crossability and accessibility.
- **Shaping Ribbon** design provides softer tip stiffness for minimized damage to the vessels, and outstanding tip shaping flexibility and stability for easy navigation.
- Nitinol + stainless steel cores provide superior flexibility and durability, improves the torque response.
- 3cm Platinum coil at distal tip provides excellent radiopacity.
- A hydrophilic coating is applied to the 30cm coiled distal end to increase the crossability and deliverability.
- PTFE coating on middle and proximal parts reduces friction, and improves pushability and catheter trackability.

Core-to-Tip



Shaping Ribbon



### Ordering Information

Core-to-Tip						
Catalogue No.	Outer Diameter	Length (cm)	Tip Flexibility	Tip Shape	Core Material	Radial Support
GW B185-0	0.014"	185	Floppy (0.6g)	Straight	NiTi + SS	Moderate
GW B185-0J	0.014"	185	Floppy (0.6g)	J	NiTi + SS	Moderate
GW B300-0	0.014"	300	Floppy (0.6g)	Straight	NiTi + SS	Moderate
GW B300-0J	0.014"	300	Floppy (0.6g)	J	NiTi + SS	Moderate
GW B185-1	0.014"	185	Super soft (1g)	Straight	NiTi + SS	Moderate
GW B185-1J	0.014"	185	Super soft (1g)	J	NiTi + SS	Moderate
GW B300-1	0.014"	300	Super soft (1g)	Straight	NiTi + SS	Moderate
GW B300-1J	0.014"	300	Super soft (1g)	J	NiTi + SS	Moderate
GW B185-2	0.014"	185	Soft (2g)	Straight	NiTi + SS	Moderate
GW B185-2J	0.014"	185	Soft (2g)	J	NiTi + SS	Moderate
GW B300-2	0.014"	300	Soft (2g)	Straight	NiTi + SS	Moderate
GW B300-2J	0.014"	300	Soft (2g)	J	NiTi + SS	Moderate

### Shaping Ribbon

Catalogue No.	Outer Diameter	Length (cm)	Tip Flexibility	Tip Shape	Core Material	Radial Support
GW B185-S0	0.014"	185	Floppy (0.6g)	Straight	NiTi + SS	Moderate
GW B185-S0J	0.014"	185	Floppy (0.6g)	J	NiTi + SS	Moderate
GW B300-S0	0.014"	300	Floppy (0.6g)	Straight	NiTi + SS	Moderate
GW B300-S0J	0.014"	300	Floppy (0.6g)	J	NiTi + SS	Moderate
GW B185-S1	0.014"	185	Super soft (1g)	Straight	NiTi + SS	Moderate
GW B185-S1J	0.014"	185	Super soft (1g)	J	NiTi + SS	Moderate
GW B300-S1	0.014"	300	Super soft (1g)	Straight	NiTi + SS	Moderate
GW B300-S1J	0.014"	300	Super soft (1g)	J	NiTi + SS	Moderate
GW B185-S2	0.014"	185	Soft (2g)	Straight	NiTi + SS	Moderate
GW B185-S2J	0.014"	185	Soft (2g)	J	NiTi + SS	Moderate
GW B300-S2	0.014"	300	Soft (2g)	Straight	NiTi + SS	Moderate
GW B300-S2J	0.014"	300	Soft (2g)	J	NiTi + SS	Moderate

# Shoocin™

## Introducer Kit



### Standard Type (Radial / Femoral / Long Sheaths)



- Advanced material improves bendability and flexibility without gapping or kinking.
- Special designed lock and silicon hemostatic valve provide outstanding hemostatic function, while guaranteeing the operational ability for the catheter.
- Smooth tapered tip helps with easy access to the artery, reducing trauma to patients.
- Smooth transition from dilator to sheath greatly reduces puncture resistance, providing easy and non-traumatic insertion.
- Minimized possibility of damaging tissue upon sheath entry, advancement and withdrawal, providing smoother and easier vascular access even through difficult access sites.

**Full kit includes:**

- Introducer Sheath (1)
- Dilator (1)
- Stainless Steel Guide Wire (1)
- Introducer Needle (1)
- Scalpel (1)
- Syringe (1)

**The Introducer Kit can be customized by:**

- Remove the every single component includes guide wire, introducer needle (IN), scalpel (K) and syringe (S).
- Replace the stainless steel guide wire (straight SS/J tip SJ) into hydrophilic guide wire (straight HS/135° angled HW) or nitinol guide wire (straight NS/J tip NJ).
- Replace the introducer needle (IN) into intravascular catheter (IC). Intravascular catheter is mandatory to be a set with hydrophilic guide wire.

Please contact the sales for more information about the selections of customized kit.

**Ordering Information\***

Long Sheath								
Catalogue No.	Sheath I.D.	Sheath Length	Guide Wire Diameter	Guide Wire Length	Introducer Needle	Scalpel	Syringe	
(Stainless Steel Guide Wire)								
LS061638-SJ80-IN18-K-S	6F	16cm	0.038"	80cm	18G	1	1	
LS062338-SJ80-IN18-K-S	6F	23cm	0.038"	80cm	18G	1	1	
LS071638-SJ80-IN18-K-S	7F	16cm	0.038"	80cm	18G	1	1	
LS072338-SJ80-IN18-K-S	7F	23cm	0.038"	80cm	18G	1	1	
LS081638-SJ80-IN18-K-S	8F	16cm	0.038"	80cm	18G	1	1	
LS082338-SJ80-IN18-K-S	8F	23cm	0.038"	80cm	18G	1	1	

Radial Sheath								
Catalogue No.	Sheath I.D.	Sheath Length	Guide Wire Diameter	Guide Wire Length	Introducer Needle	Scalpel	Syringe	
(Stainless Steel Guide Wire)								
RS040518-SS45-IN20-K-S	4F	5cm	0.018"	45cm	20G	1	1	
RS040521-SS45-IN20-K-S	4F	5cm	0.021"	45cm	20G	1	1	
RS040525-SS45-IN20-K-S	4F	5cm	0.025"	45cm	20G	1	1	
RS040718-SS45-IN20-K-S	4F	7cm	0.018"	45cm	20G	1	1	
RS040721-SS45-IN20-K-S	4F	7cm	0.021"	45cm	20G	1	1	
RS040725-SS45-IN20-K-S	4F	7cm	0.025"	45cm	20G	1	1	
RS050518-SS45-IN20-K-S	5F	5cm	0.018"	45cm	20G	1	1	
RS050521-SS45-IN20-K-S	5F	5cm	0.021"	45cm	20G	1	1	
RS050525-SS45-IN20-K-S	5F	5cm	0.025"	45cm	20G	1	1	
RS050718-SS45-IN20-K-S	5F	7cm	0.018"	45cm	20G	1	1	
RS050721-SS45-IN20-K-S	5F	7cm	0.021"	45cm	20G	1	1	
RS050725-SS45-IN20-K-S	5F	7cm	0.025"	45cm	20G	1	1	
RS060518-SS45-IN20-K-S	6F	5cm	0.018"	45cm	20G	1	1	
RS060521-SS45-IN20-K-S	6F	5cm	0.021"	45cm	20G	1	1	
RS060525-SS45-IN20-K-S	6F	5cm	0.025"	45cm	20G	1	1	
RS060718-SS45-IN20-K-S	6F	7cm	0.018"	45cm	20G	1	1	
RS060721-SS45-IN20-K-S	6F	7cm	0.021"	45cm	20G	1	1	
RS060725-SS45-IN20-K-S	6F	7cm	0.025"	45cm	20G	1	1	
RS041121-SS45-IN20-K-S	4F	11cm	0.021"	45cm	20G	1	1	
RS042421-SS70-IN20-K-S	4F	24cm	0.021"	70cm	20G	1	1	
RS051121-SS45-IN20-K-S	5F	11cm	0.021"	45cm	20G	1	1	
RS052421-SS70-IN20-K-S	5F	24cm	0.021"	70cm	20G	1	1	
RS061121-SS45-IN20-K-S	6F	11cm	0.021"	45cm	20G	1	1	
RS062421-SS70-IN20-K-S	6F	24cm	0.021"	70cm	20G	1	1	
RS070521-SS45-IN20-K-S	7F	5cm	0.021"	45cm	20G	1	1	
RS070521-SS70-IN20-K-S	7F	5cm	0.021"	70cm	20G	1	1	
RS071121-SS45-IN20-K-S	7F	11cm	0.021"	45cm	20G	1	1	
RS072421-SS70-IN20-K-S	7F	24cm	0.021"	70cm	20G	1	1	
RS070718-SS45-IN20-K-S	7F	7cm	0.018"	45cm	20G	1	1	
RS070718-SS70-IN20-K-S	7F	7cm	0.018"	70cm	20G	1	1	
RS071118-SS45-IN20-K-S	7F	11cm	0.018"	45cm	20G	1	1	
RS071118-SS70-IN20-K-S	7F	11cm	0.018"	70cm	20G	1	1	

Femoral Sheath								
Catalogue No.	Sheath I.D.	Sheath Length	Guide Wire Diameter	Guide Wire Length	Introducer Needle	Scalpel	Syringe	
(Stainless Steel Guide Wire)								
FS040525-SS45-IN20-K-S	4F	5cm	0.025"	45cm	20G	1	1	
FS041125-SS45-IN20-K-S	4F	11cm	0.025"	45cm	20G	1	1	
FS041135-SJ45-IN18-K-S	4F	11cm	0.035"	45cm	18G	1	1	
FS050535-SJ45-IN18-K-S	5F	5cm	0.035"	45cm	18G	1	1	
FS050538-SJ45-IN18-K-S	5F	5cm	0.038"	45cm	18G	1	1	
FS051135-SJ45-IN18-K-S	5F	11cm	0.035"	45cm	18G	1	1	
FS051138-SJ45-IN18-K-S	5F	11cm	0.038"	45cm	18G	1	1	
FS060535-SJ45-IN18-K-S	6F	5cm	0.035"	45cm	18G	1	1	
FS060538-SJ45-IN18-K-S	6F	5cm	0.038"	45cm	18G	1	1	
FS061135-SJ45-IN18-K-S	6F	11cm	0.035"	45cm	18G	1	1	
FS061138-SJ45-IN18-K-S	6F	11cm	0.038"	45cm	18G	1	1	
FS070535-SJ45-IN18-K-S	7F	5cm	0.035"	45cm	18G	1	1	
FS070538-SJ45-IN18-K-S	7F	5cm	0.038"	45cm	18G	1	1	
FS071135-SJ45-IN18-K-S	7F	11cm	0.035"	45cm	18G	1	1	
FS071138-SJ45-IN18-K-S	7F	11cm	0.038"	45cm	18G	1	1	
FS080535-SJ45-IN18-K-S	8F	5cm	0.035"	45cm	18G	1	1	
FS080538-SJ45-IN18-K-S	8F	5cm	0.038"	45cm	18G	1	1	
FS081135-SJ45-IN18-K-S	8F	11cm	0.035"	45cm	18G	1	1	
FS081138-SJ45-IN18-K-S	8F	11cm	0.038"	45cm	18G	1	1	
FS090538-SJ45-IN18-K-S	9F	5cm	0.038"	45cm	18G	1	1	
FS091138-SJ45-IN18-K-S	9F	11cm	0.038"	45cm	18G	1	1	

\* The Yellow Marks indicate the components which can be customized as mentioned before.  
(e.g. radial sheath/6F/7cm, 0.021" straight stainless steel guide wire/45cm, 20G introducer needle, without scalpel and syringe: RS060721-SS45-IN20)

Please contact the sales for detailed catalogue numbers of customized kits.



# Brilliant™

## Introducer Kit



### Advanced Type (Radial Sheaths)



- Hydrophilic coated radial sheath and guidewire lead to smoother navigation and easier vascular access, reducing the risk of damage to the vessel.
- Advanced material improves bendability and flexibility without gapping or kinking.
- Special designed lock and silicon hemostatic valve provide outstanding hemostatic function, while guaranteeing the operational ability for the catheter.
- Smooth tapered tip helps with easy access to the artery, reducing trauma to the patients.
- Smooth transition from dilator to sheath greatly reduces puncture resistance, providing easy and non-traumatic insertion.

**Full kit includes:**

- Introducer Sheath (1)
- Dilator (1)
- Hydrophilic Guide Wire (1)
- Intravascular Catheter (1)
- Scalpel (1)
- Syringe (1)

**The Introducer Kit can be customized by:**

- Remove the every single component includes guide wire, intravascular catheter (IC), scalpel (K) and syringe (S).
- Replace the hydrophilic guide wire (straight HS/135° angled HW) into stainless steel guide wire (straight SS) or nitinol guide wire (straight NS).
- Replace the intravascular catheter (IC) into introducer needle (IN). Intravascular catheter is mandatory to be a set with hydrophilic guide wire.

Please contact the sales for more information about the selections of customized kit.

**Ordering Information\***

Radial Sheath	Catalogue No. (Hydrophilic Guide Wire)	Sheath I.D.	Sheath Length	Guide Wire Diameter	Guide Wire Length	Intravascular Catheter	Scalpel	Syringe
	RSC040521-HS45-IC22-K-S	4F	5 cm	0.021"	45 cm	22G	1	1
	RSC040525-HS45-IC20-K-S	4F	5 cm	0.025"	45 cm	20G	1	1
	RSC040721-HS45-IC22-K-S	4F	7 cm	0.021"	45 cm	22G	1	1
	RSC040725-HS45-IC20-K-S	4F	7 cm	0.025"	45 cm	20G	1	1
	RSC041121-HS45-IC22-K-S	4F	11 cm	0.021"	45 cm	22G	1	1
	RSC041125-HS45-IC20-K-S	4F	11 cm	0.025"	45 cm	20G	1	1
	RSC041621-HS70-IC22-K-S	4F	16 cm	0.021"	70 cm	22G	1	1
	RSC041625-HS70-IC20-K-S	4F	16 cm	0.025"	70 cm	20G	1	1
	RSC042421-HS70-IC22-K-S	4F	24 cm	0.021"	70 cm	22G	1	1
	RSC042425-HS70-IC20-K-S	4F	24 cm	0.025"	70 cm	20G	1	1
	RSC050521-HS45-IC22-K-S	5F	5 cm	0.021"	45 cm	22G	1	1
	RSC050525-HS45-IC20-K-S	5F	5 cm	0.025"	45 cm	20G	1	1
	RSC050721-HS45-IC22-K-S	5F	7 cm	0.021"	45 cm	22G	1	1
	RSC050725-HS45-IC20-K-S	5F	7 cm	0.025"	45 cm	20G	1	1
	RSC051121-HS45-IC22-K-S	5F	11 cm	0.021"	45 cm	22G	1	1
	RSC051125-HS45-IC20-K-S	5F	11 cm	0.025"	45 cm	20G	1	1
	RSC051621-HS70-IC22-K-S	5F	16 cm	0.021"	70 cm	22G	1	1
	RSC051625-HS70-IC20-K-S	5F	16 cm	0.025"	70 cm	20G	1	1
	RSC052421-HS70-IC22-K-S	5F	24 cm	0.021"	70 cm	22G	1	1
	RSC052425-HS70-IC20-K-S	5F	24 cm	0.025"	70 cm	20G	1	1
	RSC060521-HS45-IC22-K-S	6F	5 cm	0.021"	45 cm	22G	1	1
	RSC060525-HS45-IC20-K-S	6F	5 cm	0.025"	45 cm	20G	1	1
	RSC060721-HS45-IC22-K-S	6F	7 cm	0.021"	45 cm	22G	1	1
	RSC060725-HS45-IC20-K-S	6F	7 cm	0.025"	45 cm	20G	1	1
	RSC061121-HS45-IC22-K-S	6F	11 cm	0.021"	45 cm	22G	1	1
	RSC061125-HS45-IC20-K-S	6F	11 cm	0.025"	45 cm	20G	1	1
	RSC061621-HS70-IC22-K-S	6F	16 cm	0.021"	70 cm	22G	1	1
	RSC061625-HS70-IC20-K-S	6F	16 cm	0.025"	70 cm	20G	1	1
	RSC062421-HS70-IC22-K-S	6F	24 cm	0.021"	70 cm	22G	1	1
	RSC062425-HS70-IC20-K-S	6F	24 cm	0.025"	70 cm	20G	1	1
	RSC070521-HS45-IC22-K-S	7F	5 cm	0.021"	45 cm	22G	1	1
	RSC070525-HS45-IC20-K-S	7F	5 cm	0.025"	45 cm	20G	1	1
	RSC070721-HS45-IC22-K-S	7F	7 cm	0.021"	45 cm	22G	1	1
	RSC070725-HS45-IC20-K-S	7F	7 cm	0.025"	45 cm	20G	1	1
	RSC071121-HS45-IC22-K-S	7F	11 cm	0.021"	45 cm	22G	1	1
	RSC071125-HS45-IC20-K-S	7F	11 cm	0.025"	45 cm	20G	1	1
	RSC071621-HS70-IC22-K-S	7F	16 cm	0.021"	70 cm	22G	1	1
	RSC071625-HS70-IC20-K-S	7F	16 cm	0.025"	70 cm	20G	1	1
	RSC072421-HS70-IC22-K-S	7F	24 cm	0.021"	70 cm	22G	1	1
	RSC072425-HS70-IC20-K-S	7F	24 cm	0.025"	70 cm	20G	1	1

\* The Yellow Marks indicate the components which can be customized as mentioned before.  
(e.g. radial sheath/6F/7cm, 0.021" straight hydrophilic guide wire/45cm, 22G intravascular catheter, without scalpel and syringe: RSC060721-HS45-IC22)  
Please contact the sales for detailed catalogue numbers of customized kits.

## Rayband™

### Radial Artery Compression Tourniquet

CE FDA



- Specially designed for radial artery hemostasis of post percutaneous puncture.
- Transparent material ensures clear visual control of hemostasis procedure.
- Unilateral valve connected to the balloon allows of accurate pressure adjustment to provide personalized hemostasis procedure.
- Adjustable band length is convenient to fit for patient's comfort.
- Stopcock on syringe helps with easy and accurate deflation.

#### Ordering Information

Catalogue No.	Balloon Structure	Bandage Length (cm)	Max Injection Air Volume (mL)	Connector
LPYP15S	1	21	15	Push-pull
LPYP15	1	24.5	15	Push-pull
LPYP15L	1	27	15	Push-pull
LPYP15XL	1	29	15	Push-pull
LPYP20S	2	21	20	Push-pull
LPYP20	2	24.5	20	Push-pull
LPYP20L	2	27	20	Push-pull
LPYP20XL	2	29	20	Push-pull
YPR15S	1	21	15	Luer
YPR15	1	24.5	15	Luer
YPR15L	1	27	15	Luer
YPR15XL	1	29	15	Luer
YPR20S	2	21	20	Luer
YPR20	2	24.5	20	Luer
YPR20L	2	27	20	Luer
YPR20XL	2	29	20	Luer

## Angioway™

### Y-Hemostasis Valve Set

CE FDA



- Effectively minimize blood loss and provide a smooth channel for interventional device delivery.
- Easy push-pull mechanism allows to operate with one hand.

#### Whole set package includes:

- Y-valve (1)
- Guide Wire Torquer (1)
- Guide Wire Introducer (1)

#### Technical Parameters

Connector Type	Push-Pull / Rotating
Inner Diameter	0.118" (3.0mm)
Body Material	Polycarbonate
Extension Tubing	Optional
Sterilization	ETO

#### Ordering Information

Catalogue No.	Connector Type	Package Type	Length of the Extension Tubing (cm)
YNP	Push-Pull	Whole set	/
YNP20	Push-Pull	Whole set	20
YNP25	Push-Pull	Whole set	25
YNP40	Push-Pull	Whole set	40
YNP50	Push-Pull	Whole set	50
YNPH	Push-Pull	Y-valve only	/
YNP20H	Push-Pull	Y-valve only	20
YNP25H	Push-Pull	Y-valve only	25
YNP40H	Push-Pull	Y-valve only	40
YNP50H	Push-Pull	Y-valve only	50
YNR	Rotating	Whole set	/
YNRH	Rotating	Y-valve only	/

# Angiopower™

## Inflation Device

CE FDA



- Fluorescence clock face for clearer display.
- Smooth fine adjustment for accurate inflation.
- Barrier screw pivot provides precise pressure placement.
- The internal multi-buckle structure ensures more secure lock.
- Ergonomic grip fits comfortably in either hand.
- Petal-shaped handle ensures torque control without slipping.

### Technical Parameter

Display	Analog/Fluorescent
Pressure	30 atm (440psi)
Barrel Volume	20mL
Stopcock	3-way 500psi
Extension Tubing	33cm, 1200psi, male rotating Luer connector

### Ordering Information

Catalogue No.	Inflation Range (atm)	Stopcock
LP-P-30	30	/
LP-P-30S	30	Included

# Inflation Devices Kit

CE FDA



### Inflation Device Kit includes:

- Inflation Device (1)
- Y-Hemostasis Valve Set (1)

### Ordering Information

Catalogue No.	Inflation Device Model		Y-Hemostasis Valve Set Model			
	Type	Inflation Range	Type	Mode	Contains	Extension Tubing
LP-P-30-YNP	LP-P-30	30atm	YNP	Push-Pull	Whole set	/
LP-P-30-YNP20	LP-P-30	30atm	YNP20	Push-Pull	Whole set	20cm
LP-P-30-YNP25	LP-P-30	30atm	YNP25	Push-Pull	Whole set	25cm
LP-P-30-YNP40	LP-P-30	30atm	YNP40	Push-Pull	Whole set	40cm
LP-P-30-YNP50	LP-P-30	30atm	YNP50	Push-Pull	Whole set	50cm
LP-P-30-YNPH	LP-P-30	30atm	YNPH	Push-Pull	Y-valve only	/
LP-P-30-YNP20H	LP-P-30	30atm	YNP20H	Push-Pull	Y-valve only	20cm
LP-P-30-YNP25H	LP-P-30	30atm	YNP25H	Push-Pull	Y-valve only	25cm
LP-P-30-YNP40H	LP-P-30	30atm	YNP40H	Push-Pull	Y-valve only	40cm
LP-P-30-YNP50H	LP-P-30	30atm	YNP50H	Push-Pull	Y-valve only	50cm
LP-P-30-YNR	LP-P-30	30atm	YNR	Rotating	Whole set	/
LP-P-30-YNRH	LP-P-30	30atm	YNRH	Rotating	Y-valve only	/
LP-P-30S-YNP	LP-P-30S	30atm	YNP	Push-Pull	Whole set	/
LP-P-30S-YNP20	LP-P-30S	30atm	YNP20	Push-Pull	Whole set	20cm
LP-P-30S-YNP25	LP-P-30S	30atm	YNP25	Push-Pull	Whole set	25cm
LP-P-30S-YNP40	LP-P-30S	30atm	YNP40	Push-Pull	Whole set	40cm
LP-P-30S-YNP50	LP-P-30S	30atm	YNP50	Push-Pull	Whole set	50cm
LP-P-30S-YNPH	LP-P-30S	30atm	YNPH	Push-Pull	Y-valve only	/
LP-P-30S-YNP20H	LP-P-30S	30atm	YNP20H	Push-Pull	Y-valve only	20cm
LP-P-30S-YNP25H	LP-P-30S	30atm	YNP25H	Push-Pull	Y-valve only	25cm
LP-P-30S-YNP40H	LP-P-30S	30atm	YNP40H	Push-Pull	Y-valve only	40cm
LP-P-30S-YNP50H	LP-P-30S	30atm	YNP50H	Push-Pull	Y-valve only	50cm
LP-P-30S-YNR	LP-P-30S	30atm	YNR	Rotating	Whole set	/
LP-P-30S-YNRH	LP-P-30S	30atm	YNRH	Rotating	Y-valve only	/

## Angioway™

### Manifolds

CE

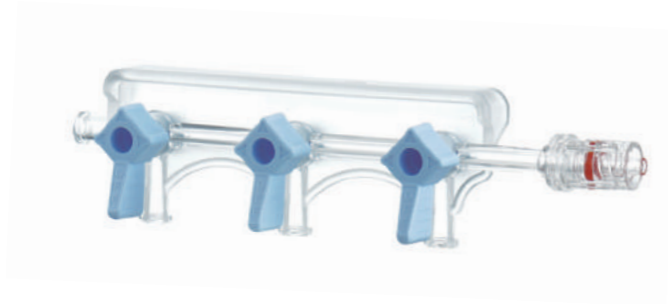

- Visible handle makes the flow control easy and accurate
- On / Off types are available for different user habits

#### Technical Parameters

Side Ports	One / Two / Three
Pressure	500psi
Valve Type	On / Off
Extension Tubing	Optional
Sterilization	ETO

#### Ordering Information

Catalogue No.	Pressure	Side Port	Valve Type	Extension Tubing
LPJD502N	500psi	2	On	/
LPJD502F	500psi	2	Off	/
LPJD503N	500psi	3	On	/
LPJD503F	500psi	3	Off	/
LPJD503NX	500psi	3	On	Included
LPJD503FX	500psi	3	Off	Included

## Angioway™

### High Pressure Extension Tubings

CE



- High pressure transparent material ensures the need for large flow
- Customized length is available

#### Technical Parameters

Material	PVC/TPU
Inner Diameter	0.056" (1.44mm)
Pressure Resistance	500psi / 1200psi
Sterilization	ETO

#### Ordering Information

Pressure	Length					
	30cm	60cm	90cm	120cm	150cm	180cm
500psi	LPJG30N	LPJG60N	LPJG90N	LPJG120N	LPJG150N	LPJG180N
1200psi	LPJG30H	LPJG60H	LPJG90H	LPJG120H	LPJG150H	LPJG180H

## Introducer Needle

CE



### Ordering Information

Catalogue No.	Gauge	Guide Wire Compatibility	Working Length (mm)
MMN 1870	18	0.035"	70
MMN 2038	20	0.021"	38
MMNI 1870	18	0.038"	70

## Angiospring™

### Angiography Control Syringe

CE



- Solid and smooth plunger with unique push button make it easy for operation
- Clear scale, accurate control of infusion volume
- Latex free

### Technical Parameters

Luer Connector Type	Rotating
Sterilization	ETO

### Ordering Information

Catalogue No.	Connector Type	Nominal Capacity (mL)
LPHB112	Rotating	12

## Contrast Medium Injection Manifold Kits

CE



### Contrast Medium Injection Manifold Kit includes:

- Manifold (1)
- Angiography Control Syringe (1)
- High Pressure Extension Tubing (1)
- Infusion set (2)

### Ordering Information

Catalogue No.	Manifold Model	Control Syringe Model	High Pressure Extension Tubing Model	Infusion Set Model
MK-005	LPJD253N	LPHB112	LPJG30	IS-G-V IS-G-V3
MK-006	LPJD253N	LPHB112	LPJG60	IS-G-V IS-G-V3
MK-007	LPJD253N	LPHB112	LPJG90	IS-G-V IS-G-V3
MK-008	LPJD253N	LPHB112	LPJG120	IS-G-V IS-G-V3
MK-017	LPJD253F	LPHB112	LPJG30	IS-G-V IS-G-V3
MK-018	LPJD253F	LPHB112	LPJG60	IS-G-V IS-G-V3
MK-019	LPJD253F	LPHB112	LPJG90	IS-G-V IS-G-V3
MK-020	LPJD253F	LPHB112	LPJG120	IS-G-V IS-G-V3



# 02

## Neurovascular Interventional Products

### Vascular Protection

39 Disposable Embolic Protection Device **CE**

### Embolization

40 Embolic Coil System **CE**

### Microcatheter

41 Disposable Microcatheter **CE**

## Disposable Embolic Protection Device

CE



- Nitinol material with great hemocompatibility. Soft braided filter and round distal tip minimize the risk of trauma to the vessel.
- Excellent axial control and kink resistance provide superior deliverability and crossability through tortuous anatomy.
- Gold loop marker could identify the release status of the filter, which ensures the optimal positioning of the filter in the vessel.
- The unique design of guidewire casing on the filter prevents from its displacement caused by the movement of guidewire.
- Gradient pore diameter from distal to proximal end guarantees efficient embolus capturing while maintaining continuous blood flow.
- Integrated sheaths for delivery and retrieval are compatible with 5F/6F catheters and 0.014" guidewire, which could achieve rapid exchange during the procedure.

### Ordering Information

Catalogue No.	Filter Diameter (mm)	Guide Wire Length (cm)	Delivery Shaft O.D.	Retrieval Shaft O.D.
TJEP03-190	3	190	3.2F	4.2F
TJEP04-190	4	190	3.2F	4.2F
TJEP05-190	5	190	3.2F	4.2F
TJEP06-190	6	190	3.2F	4.2F
TJEP07-190	7	190	3.2F	4.2F
TJEP08-190	8	190	3.2F	4.2F
TJEP03-320	3	320	3.2F	4.2F
TJEP04-320	4	320	3.2F	4.2F
TJEP05-320	5	320	3.2F	4.2F
TJEP06-320	6	320	3.2F	4.2F
TJEP07-320	7	320	3.2F	4.2F
TJEP08-320	8	320	3.2F	4.2F

Notice: Please contact the sales for detailed information before placing the order.

## Embolic Coil System

CE

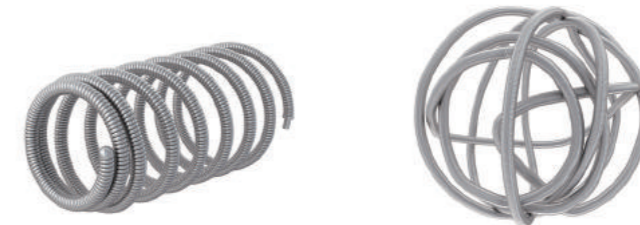

2D Helical Structure

3D Complex Structure

- Gradient primary diameter ranges from 0.010" to 0.014", providing different softness with better compliance.
- Anti-unwinding structure prevents from coil unwinding which is caused by over-stretching during the embolization process.
- Markers on proximal end of the coil and the distal end of the delivery shaft provide accurate positioning.
- Stable detachment leads to safer operation. One single coil could be detached completely within 1 second.
- This product is compatible with most of the microcatheters in the market.

### Ordering Information

Minimal microcatheter inner diameter compatibility: 0.0165"

Catalogue No. (helical)	Catalogue No. (complex)	Loop Dia. (mm)	Effective Length (cm)	Catalogue No. (helical)	Catalogue No. (complex)	Loop Dia. (mm)	Effective Length (cm)
TJCST1.502-2D	TJCST1.502-3D	1.5	2	TJCST0509-2D	TJCST0509-3D	5	9
TJCST1.503-2D	TJCST1.503-3D	1.5	3	TJCST0510-2D	TJCST0510-3D	5	10
TJCST1.504-2D	TJCST1.504-3D	1.5	4	TJCST0515-2D	TJCST0515-3D	5	15
TJCST0201-2D	TJCST0201-3D	2	1	TJCST0520-2D	TJCST0520-3D	5	20
TJCST0202-2D	TJCST0202-3D	2	2	TJCST0610-2D	TJCST0610-3D	6	10
TJCST0203-2D	TJCST0203-3D	2	3	TJCST0611-2D	TJCST0611-3D	6	11
TJCST0204-2D	TJCST0204-3D	2	4	TJCST0615-2D	TJCST0615-3D	6	15
TJCST0206-2D	TJCST0206-3D	2	6	TJCST0620-2D	TJCST0620-3D	6	20
TJCST0208-2D	TJCST0208-3D	2	8	TJCST0715-2D	TJCST0715-3D	7	15
TJCST2.502-2D	TJCST2.502-3D	2.5	2	TJCST0720-2D	TJCST0720-3D	7	20
TJCST2.504-2D	TJCST2.504-3D	2.5	4	TJCST0730-2D	TJCST0730-3D	7	30
TJCST2.506-2D	TJCST2.506-3D	2.5	6	TJCST0815-2D	TJCST0815-3D	8	15
TJCST2.508-2D	TJCST2.508-3D	2.5	8	TJCST0820-2D	TJCST0820-3D	8	20
TJCST0304-2D	TJCST0304-3D	3	4	TJCST0830-2D	TJCST0830-3D	8	30
TJCST0306-2D	TJCST0306-3D	3	6	TJCST0920-2D	TJCST0920-3D	9	20
TJCST0308-2D	TJCST0308-3D	3	8	TJCST0930-2D	TJCST0930-3D	9	30
TJCST0310-2D	TJCST0310-3D	3	10	TJCST1020-2D	TJCST1020-3D	10	20
TJCST0312-2D	TJCST0312-3D	3	12	TJCST1030-2D	TJCST1030-3D	10	30
TJCST3.506-2D	TJCST3.506-3D	3.5	6	TJCST1130-2D	TJCST1130-3D	11	30
TJCST3.508-2D	TJCST3.508-3D	3.5	8	TJCST1230-2D	TJCST1230-3D	12	30
TJCST3.510-2D	TJCST3.510-3D	3.5	10	TJCST1330-2D	TJCST1330-3D	13	30
TJCST3.512-2D	TJCST3.512-3D	3.5	12	TJCST1430-2D	TJCST1430-3D	14	30
TJCST0404-2D	TJCST0404-3D	4	4	TJCST1530-2D	TJCST1530-3D	15	30
TJCST0406-2D	TJCST0406-3D	4	6	TJCST1630-2D	TJCST1630-3D	16	30
TJCST0408-2D	TJCST0408-3D	4	8	TJCST1830-2D	TJCST1830-3D	18	30
TJCST0410-2D	TJCST0410-3D	4	10	TJCST2030-2D	TJCST2030-3D	20	30
TJCST4.506-2D	TJCST4.506-3D	4.5	6				
TJCST4.508-2D	TJCST4.508-3D	4.5	8				
TJCST4.510-2D	TJCST4.510-3D	4.5	10				
TJCST4.512-2D	TJCST4.512-3D	4.5	12				
TJCST4.515-2D	TJCST4.515-3D	4.5	15				

Notice: Please contact the sales for detailed information before placing the order.

**Disposable  
Microcatheter**

CE

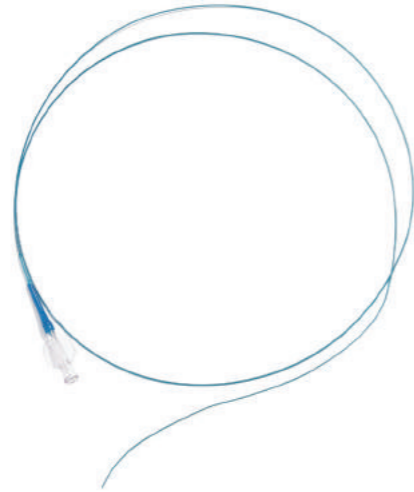

- Three-layer structure of the microcatheter contributes to the high static pressure resistance, which could reach up to 600psi (4137KPa).
- Multi-segments design with smooth transition ensures excellent flexibility, crossability and pushability during delivery.
- The long distal soft segment improves the sensitivity of the catheter during delivery.
- Soft segment is covered by coiled Pt-W alloy, which provides great radiopacity and better trackability in the vessel.
- Ultra-soft tip ensures better plasticity even for multiple times of tip shaping.
- Hydrophilic coating on the whole catheter provides outstanding deliverability.

**Ordering Information**

Catalogue No.	Catheter I.D.	Catheter Distal O.D.	Catheter Proximal O.D.	Effective Length	Max. Guide Wire O.D.	Tip Shape	Markers
TJMC10	0.015"	1.8F	2.2F	150cm	0.012"	Straight, Steam Shapeable	2
TJMC14	0.0165"	1.9F	2.3F	150cm	0.014"	Straight, Steam Shapeable	2
TJMC16	0.021"	2.3F	2.8F	150cm	0.018"	Straight, Steam Shapeable	2
TJMC18	0.027"	2.5F	2.8F	140cm	0.021"	Straight, Steam Shapeable	1

Notice: Please contact the sales for detailed information before placing the order.

# 03 Peripheral Interventional Products

**PTA Balloon**

43 Supercross™ PTA Balloon Dilatation Catheter CE



# Supercross™

## PTA Balloon Dilatation Catheter



- The flexible tapered tip ensures consistently smooth insertion and atraumatic navigation.
- Low crossing profile guarantees excellent crossability to pass through narrow lesions.
- Over the wire (OTW) design provides great torque control, kink resistance and pushability to ensure the outstanding deliverability.
- Dual-lumen shaft design of the OTW catheter separates the inflation lumen and guide wire lumen to ensure the rapid deflation performance.
- Special memory folding technique provides great withdrawal capability, and allows of repeated dilatation.

### Technical Parameters

Catheter Design	Rapid Exchange (RX)
Balloon Compliance	Semi-compliant
Marker	2
Material	Nylon
Nominal Pressure	7 atm
Distal Shaft O.D.	2.8F
Proximal Shaft O.D.	2.3F
Lowest Crossing Profile	0.025"
Effective Length	135cm
Minimum Guiding Catheter Compatibility	5F (0.056")
Guide wire Compatibility	0.014"

Catheter Design	Over the Wire (OTW)
Balloon Compliance	Semi-compliant
Marker	2
Material	Nylon
Nominal Pressure	7 atm
Distal Shaft O.D.	5F
Lowest Crossing Profile	0.060"
Effective Length	80cm / 135cm
Minimum Introducer Sheath Compatibility	5F / 6F / 7F
Guide Wire Compatibility	0.035"

### Ordering Information

Rapid Exchange							
Balloon Diameter (mm)	Balloon Length (mm)						
	20	30	40	60	80	100	120
1.5	PTAR15020	/	/	/	/	/	/
2.0	PTAR20020	PTAR20030	PTAR20040	PTAR20060	PTAR20080	PTAR20100	PTAR20120
2.5	PTAR25020	PTAR25030	PTAR25040	PTAR25060	PTAR25080	PTAR25100	PTAR25120
3.0	PTAR30020	PTAR30030	PTAR30040	PTAR30060	PTAR30080	PTAR30100	PTAR30120
3.5	PTAR35020	PTAR35030	PTAR35040	PTAR35060	PTAR35080	PTAR35100	PTAR35120
4.0	PTAR40020	PTAR40030	PTAR40040	PTAR40060	PTAR40080	PTAR40100	PTAR40120
4.5	PTAR45020	PTAR45030	PTAR45040	PTAR45060	PTAR45080	PTAR45100	PTAR45120
5.0	PTAR50020	PTAR50030	PTAR50040	PTAR50060	PTAR50080	PTAR50100	PTAR50120
5.5	PTAR55020	PTAR55030	PTAR55040	PTAR55060	PTAR55080	PTAR55100	PTAR55120
6.0	PTAR60020	PTAR60030	PTAR60040	PTAR60060	PTAR60080	PTAR60100	PTAR60120
7.0	PTAR70020	PTAR70030	PTAR70040	PTAR70060	PTAR70080	PTAR70100	PTAR70120

Over the Wire (Effective length is 80cm)							
Balloon Diameter (mm)	Balloon Length (mm)						
	20	30	40	60	80	100	120
3.0	PTAO30020	PTAO30030	PTAO30040	PTAO30060	PTAO30080	PTAO30100	PTAO30120
3.5	PTAO35020	PTAO35030	PTAO35040	PTAO35060	PTAO35080	PTAO35100	PTAO35120
4.0	PTAO40020	PTAO40030	PTAO40040	PTAO40060	PTAO40080	PTAO40100	PTAO40120
4.5	PTAO45020	PTAO45030	PTAO45040	PTAO45060	PTAO45080	PTAO45100	PTAO45120
5.0	PTAO50020	PTAO50030	PTAO50040	PTAO50060	PTAO50080	PTAO50100	PTAO50120
5.5	PTAO55020	PTAO55030	PTAO55040	PTAO55060	PTAO55080	PTAO55100	PTAO55120
6.0	PTAO60020	PTAO60030	PTAO60040	PTAO60060	PTAO60080	PTAO60100	PTAO60120
7.0	PTAO70020	PTAO70030	PTAO70040	PTAO70060	PTAO70080	PTAO70100	PTAO70120
8.0	PTAO80020	PTAO80030	PTAO80040	PTAO80060	PTAO80080	PTAO80100	PTAO80120
9.0	PTAO90020	PTAO90030	PTAO90040	PTAO90060	PTAO90080	PTAO90100	PTAO90120
10.0	PTAO10020	PTAO10030	PTAO10040	PTAO10060	PTAO10080	PTAO10100	PTAO10120
12.0	PTAO12020	/	/	/	/	/	/

Over the Wire (Effective length is 135cm)							
Balloon Diameter (mm)	Balloon Length (mm)						
	20	30	40	60	80	100	120
3.0	PTAO30020 L	PTAO30030 L	PTAO30040 L	PTAO30060 L	PTAO30080 L	PTAO30100 L	PTAO30120 L
3.5	PTAO35020 L	PTAO35030 L	PTAO35040 L	PTAO35060 L	PTAO35080 L	PTAO35100 L	PTAO35120 L
4.0	PTAO40020 L	PTAO40030 L	PTAO40040 L	PTAO40060 L	PTAO40080 L	PTAO40100 L	PTAO40120 L
4.5	PTAO45020 L	PTAO45030 L	PTAO45040 L	PTAO45060 L	PTAO45080 L	PTAO45100 L	PTAO45120 L
5.0	PTAO50020 L	PTAO50030 L	PTAO50040 L	PTAO50060 L	PTAO50080 L	PTAO50100 L	PTAO50120 L
5.5	PTAO55020 L	PTAO55030 L	PTAO55040 L	PTAO55060 L	PTAO55080 L	PTAO55100 L	PTAO55120 L
6.0	PTAO60020 L	PTAO60030 L	PTAO60040 L	PTAO60060 L	PTAO60080 L	PTAO60100 L	PTAO60120 L
7.0	PTAO70020 L	PTAO70030 L	PTAO70040 L	PTAO70060 L	PTAO70080 L	PTAO70100 L	PTAO70120 L
8.0	PTAO80020 L	PTAO80030 L	PTAO80040 L	PTAO80060 L	PTAO80080 L	PTAO80100 L	PTAO80120 L
9.0	PTAO90020 L	PTAO90030 L	PTAO90040 L	PTAO90060 L	PTAO90080 L	PTAO90100 L	PTAO90120 L
10.0	PTAO10020 L	PTAO10030 L	PTAO10040 L	PTAO10060 L	PTAO10080 L	PTAO10100 L	PTAO10120 L
12.0	PTAO12020 L	/	/	/	/	/	/

# 04

## Structural Heart Diseases Products



### Occlusion Devices

- 47 MemoPart™ Atrial Septal Defect (ASD) Occluder CE
- 49 MemoPart™ Ventricular Septal Defect (VSD) Occluder CE
- 52 MemoPart™ Patent Ductus Arteriosus (PDA) Occluder CE
- 54 MemoPart™ Patent Foramen Ovale (PFO) Occluder CE
- 55 MemoPart™ Plug CE
- 56 MemoPart™ Occluder Delivery System CE
- 58 MemoPart™ Snare CE

### Mechanical Heart Valves

- 59 GK-3 Single-leaflet Prosthetic Heart Valve
- 60 GKS Bi-leaflet Prosthetic Heart Valve

# MemoPart™

## Atrial Septal Defect (ASD) Occluder

CE



ASD Occluder

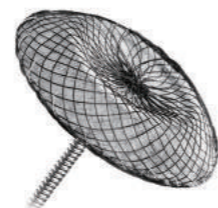

Hubless ASD Occluder

- Modified rigidity and flexibility for different type of occluders - greater stiffness of ASDO offers excellent supporting force for big disks.
- Uniform and smooth oxide film on nitinol wire effectively prevents from the release of nickel ion to guarantee the great biocompatibility and long-term safety.
- Hubless design helps with earlier endothelialization to minimize the risk of thrombosis.

### Ordering Information

#### ASD Occluder

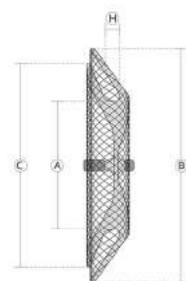

Catalogue No.	Device Size	A Waist Diameter (mm)	B LA Disc Diameter (mm)	C RA Disc Diameter (mm)	H Waist Length (mm)
FQFDQ- I 06	06	6	16	14	3.0
FQFDQ- I 07	07	7	21	17	3.0
FQFDQ- I 08	08	8	18	16	3.0
FQFDQ- I 09	09	9	23	19	3.0
FQFDQ- I 10	10	10	20	18	3.0
FQFDQ- I 11	11	11	25	21	3.0
FQFDQ- I 12	12	12	22	20	3.0
FQFDQ- I 13	13	13	27	23	3.0
FQFDQ- I 14	14	14	24	22	3.0
FQFDQ- I 15	15	15	29	25	4.0
FQFDQ- I 16	16	16	30	26	4.0
FQFDQ- I 17	17	17	31	27	4.0
FQFDQ- I 18	18	18	32	28	4.0
FQFDQ- I 19	19	19	33	29	4.0
FQFDQ- I 20	20	20	34	30	4.0
FQFDQ- I 22	22	22	36	32	4.0
FQFDQ- I 24	24	24	38	34	4.0
FQFDQ- I 26	26	26	40	36	4.0
FQFDQ- I 28	28	28	42	38	4.0
FQFDQ- I 30	30	30	44	40	4.0
FQFDQ- I 32	32	32	47	42	4.0
FQFDQ- I 34	34	34	49	44	4.0
FQFDQ- I 36	36	36	51	46	4.0
FQFDQ- I 38	38	38	54	50	4.5
FQFDQ- I 40	40	40	56	52	4.5
FQFDQ- I 42	42	42	58	54	4.5
FQFDQ- I 44	44	44	60	56	4.5
FQFDQ- I 46	46	46	62	58	4.5
FQFDQ- I 48	48	48	64	60	4.5
FQFDQ- I 50	50	50	66	62	4.5

#### Hubless ASD Occluder

Catalogue No.	Device Size	A Waist Diameter (mm)	B LA Disc Diameter (mm)	C RA Disc Diameter (mm)	H Waist Length (mm)
WTFQFDQ- I 06	06	6	16	14	3.0
WTFQFDQ- I 07	07	7	21	17	3.0
WTFQFDQ- I 08	08	8	18	16	3.0
WTFQFDQ- I 09	09	9	23	19	3.0
WTFQFDQ- I 10	10	10	20	18	3.0
WTFQFDQ- I 11	11	11	25	21	3.0
WTFQFDQ- I 12	12	12	22	20	3.0
WTFQFDQ- I 13	13	13	27	23	3.0
WTFQFDQ- I 14	14	14	24	22	3.0
WTFQFDQ- I 15	15	15	29	25	4.0
WTFQFDQ- I 16	16	16	30	26	4.0
WTFQFDQ- I 17	17	17	31	27	4.0
WTFQFDQ- I 18	18	18	32	28	4.0
WTFQFDQ- I 19	19	19	33	29	4.0
WTFQFDQ- I 20	20	20	34	30	4.0
WTFQFDQ- I 22	22	22	36	32	4.0
WTFQFDQ- I 24	24	24	38	34	4.0

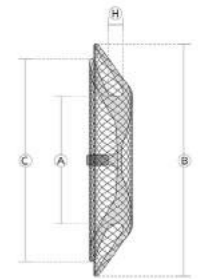

#### Multi-Fenestrated ASD Occluder

Catalogue No.	Device Size	A Waist Diameter (mm)	B LA Disc Diameter (mm)	C RA Disc Diameter (mm)	H Waist Length (mm)
FQFDQ- II 06	06	6	30	22	3.0
FQFDQ- II 08	08	8	32	24	3.0
FQFDQ- II 10	10	10	34	26	3.0
FQFDQ- II 12	12	12	36	28	3.0
FQFDQ- II 14	14	14	38	30	3.0
FQFDQ- II 16	16	16	40	32	4.0
FQFDQ- II 18	18	18	42	34	4.0
FQFDQ- II 20	20	20	44	36	4.0
FQFDQ- II 22	22	22	46	38	4.0
FQFDQ- II 24	24	24	48	40	4.0

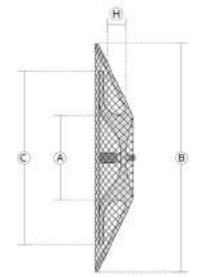

#### Hubless Multi-Fenestrated ASD Occluder

Catalogue No.	Device Size	A Waist Diameter (mm)	B LA Disc Diameter (mm)	C RA Disc Diameter (mm)	H Waist Length (mm)
WTFQFDQ- II 06	06	6	30	22	3.0
WTFQFDQ- II 08	08	8	32	24	3.0
WTFQFDQ- II 10	10	10	34	26	3.0
WTFQFDQ- II 12	12	12	36	28	3.0
WTFQFDQ- II 14	14	14	38	30	3.0

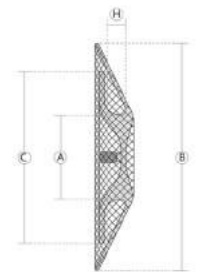

# MemoPart™

## Ventricular Septal Defect (VSD) Occluder



VSD Occluder



Hubless VSD Occluder

- Modified rigidity and flexibility for different type of occluders - less stiffness of VSDO reduces the holding force to minimize the risk of third degree atrioventricular block.
- Different waist lengths of VSD occluders minimize the negative impact of compress force to the patients.
- Uniform and smooth oxide film on nitinol wire effectively prevents from the release of nickel ion to guarantee the great biocompatibility and long-term safety.
- Hubless design helps with earlier endothelialization to minimize the risk of thrombosis.

### Ordering Information

#### Muscular VSD Occluder

Catalogue No.	Device Size	A Waist Diameter (mm)	B LV Disc Diameter (mm)	C RV Disc Diameter (mm)	H Waist Length (mm)
SQFDQ- I a04	04	4	8	8	5.0
SQFDQ- I a05	05	5	9	9	5.0
SQFDQ- I a06	06	6	10	10	5.0
SQFDQ- I a07	07	7	11	11	5.0
SQFDQ- I a08	08	8	12	12	5.0
SQFDQ- I a09	09	9	13	13	5.0
SQFDQ- I a10	10	10	14	14	5.0
SQFDQ- I a12	12	12	16	16	5.0
SQFDQ- I a14	14	14	18	18	5.0
SQFDQ- I a16	16	16	20	20	5.0
SQFDQ- I a18	18	18	22	22	5.0
SQFDQ- I b04	04	4	10	8	7.0
SQFDQ- I b05	05	5	11	9	7.0
SQFDQ- I b06	06	6	12	10	7.0
SQFDQ- I b07	07	7	13	11	7.0
SQFDQ- I b08	08	8	14	12	7.0
SQFDQ- I b09	09	9	15	13	7.0
SQFDQ- I b10	10	10	16	14	7.0
SQFDQ- I b12	12	12	18	16	7.0
SQFDQ- I b14	14	14	20	18	7.0
SQFDQ- I b16	16	16	22	20	7.0
SQFDQ- I b18	18	18	24	22	7.0
SQFDQ- I c04	04	4	14	10	10.0
SQFDQ- I c05	05	5	15	11	10.0
SQFDQ- I c06	06	6	16	12	10.0
SQFDQ- I c07	07	7	17	13	10.0
SQFDQ- I c08	08	8	18	14	10.0
SQFDQ- I c09	09	9	19	15	10.0
SQFDQ- I c10	10	10	20	16	10.0
SQFDQ- I c12	12	12	22	18	10.0
SQFDQ- I c14	14	14	24	20	10.0
SQFDQ- I c16	16	16	26	22	10.0
SQFDQ- I c18	18	18	28	24	10.0

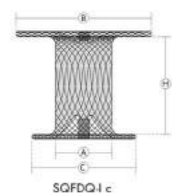
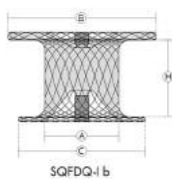
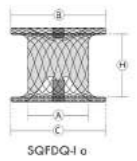

#### Hubless Muscular VSD Occluder

Catalogue No.	Device Size	A Waist Diameter (mm)	B LV Disc Diameter (mm)	C RV Disc Diameter (mm)	H Waist Length (mm)
WTSQFDQ- I a04	04	4	8	8	5.0
WTSQFDQ- I a05	05	5	9	9	5.0
WTSQFDQ- I a06	06	6	10	10	5.0
WTSQFDQ- I a07	07	7	11	11	5.0
WTSQFDQ- I a08	08	8	12	12	5.0
WTSQFDQ- I a09	09	9	13	13	5.0
WTSQFDQ- I a10	10	10	14	14	5.0
WTSQFDQ- I a12	12	12	16	16	5.0
WTSQFDQ- I a14	14	14	18	18	5.0
WTSQFDQ- I a16	16	16	20	20	5.0
WTSQFDQ- I a18	18	18	22	22	5.0
WTSQFDQ- I b04	04	4	10	8	7.0
WTSQFDQ- I b05	05	5	11	9	7.0
WTSQFDQ- I b06	06	6	12	10	7.0
WTSQFDQ- I b07	07	7	13	11	7.0
WTSQFDQ- I b08	08	8	14	12	7.0
WTSQFDQ- I b09	09	9	15	13	7.0
WTSQFDQ- I b10	10	10	16	14	7.0
WTSQFDQ- I b12	12	12	18	16	7.0
WTSQFDQ- I b14	14	14	20	18	7.0
WTSQFDQ- I b16	16	16	22	20	7.0
WTSQFDQ- I b18	18	18	24	22	7.0
WTSQFDQ- I c04	04	4	14	10	10.0
WTSQFDQ- I c05	05	5	15	11	10.0
WTSQFDQ- I c06	06	6	16	12	10.0
WTSQFDQ- I c07	07	7	17	13	10.0
WTSQFDQ- I c08	08	8	18	14	10.0
WTSQFDQ- I c09	09	9	19	15	10.0
WTSQFDQ- I c10	10	10	20	16	10.0
WTSQFDQ- I c12	12	12	22	18	10.0
WTSQFDQ- I c14	14	14	24	20	10.0
WTSQFDQ- I c16	16	16	26	22	10.0
WTSQFDQ- I c18	18	18	28	24	10.0

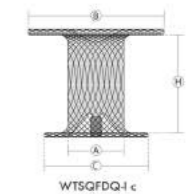

#### Membranous Symmetric VSD Occluder

Catalogue No.	Device Size	A Waist Diameter (mm)	B LV Disc Diameter (mm)	C RV Disc Diameter (mm)	H Waist Length (mm)
SQFDQ- II b04	04	4	8	8	3.5
SQFDQ- II b05	05	5	9	9	4.0
SQFDQ- II b06	06	6	10	10	4.0
SQFDQ- II b07	07	7	11	11	4.0
SQFDQ- II b08	08	8	12	12	4.0
SQFDQ- II b09	09	9	13	13	4.5
SQFDQ- II b10	10	10	14	14	4.5
SQFDQ- II b12	12	12	16	15	4.5
SQFDQ- II b14	14	14	18	17	4.5
SQFDQ- II b16	16	16	22	20	5.0
SQFDQ- II b18	18	18	24	22	5.0
SQFDQ- II b20	20	20	26	24	5.0

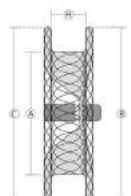

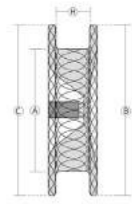

**Hubless Membranous Symmetric VSD Occluder**

Catalogue No.	Device Size	A Waist Diameter (mm)	B LV Disc Diameter (mm)	C RV Disc Diameter (mm)	H Waist Length (mm)
WTSQFDQ- II b04	04	4	8	8	3.5
WTSQFDQ- II b05	05	5	9	9	4.0
WTSQFDQ- II b06	06	6	10	10	4.0
WTSQFDQ- II b07	07	7	11	11	4.0
WTSQFDQ- II b08	08	8	12	12	4.0
WTSQFDQ- II b09	09	9	13	13	4.5
WTSQFDQ- II b10	10	10	14	14	4.5
WTSQFDQ- II b12	12	12	16	15	4.5
WTSQFDQ- II b14	14	14	18	17	4.5
WTSQFDQ- II b16	16	16	22	20	5.0
WTSQFDQ- II b18	18	18	24	22	5.0
WTSQFDQ- II b20	20	20	26	24	5.0

**Membranous Asymmetric VSD Occluder for Multi-Fenestrated Defects**

Catalogue No.	Device Size	A Waist Diameter (mm)	B LV Disc Diameter (mm)	C RV Disc Diameter (mm)	H Waist Length (mm)
SQFDQ- III 04	04	4	12	8	3.5
SQFDQ- III 05	05	5	13	9	4.0
SQFDQ- III 06	06	6	14	10	4.0
SQFDQ- III 07	07	7	15	11	4.0
SQFDQ- III 08	08	8	16	12	4.0
SQFDQ- III 09	09	9	17	13	4.5
SQFDQ- III 10	10	10	18	14	4.5
SQFDQ- III 12	12	12	20	16	4.5
SQFDQ- III 14	14	14	22	18	4.5
SQFDQ- III 16	16	16	24	20	5.0
SQFDQ- III 18	18	18	26	22	5.0

**Hubless Membranous Asymmetric VSD Occluder for Multi-Fenestrated Defects**

Catalogue No.	Device Size	A Waist Diameter (mm)	B LV Disc Diameter (mm)	C RV Disc Diameter (mm)	H Waist Length (mm)
WTSQFDQ- III 04	04	4	12	8	3.5
WTSQFDQ- III 05	05	5	13	9	4.0
WTSQFDQ- III 06	06	6	14	10	4.0
WTSQFDQ- III 07	07	7	15	11	4.0
WTSQFDQ- III 08	08	8	16	12	4.0
WTSQFDQ- III 09	09	9	17	13	4.5
WTSQFDQ- III 10	10	10	18	14	4.5
WTSQFDQ- III 12	12	12	20	16	4.5
WTSQFDQ- III 14	14	14	22	18	4.5
WTSQFDQ- III 16	16	16	24	20	5.0
WTSQFDQ- III 18	18	18	26	22	5.0

**Zero Rim Eccentric VSDO for the Defect Close to Aortic Valve**

Catalogue No.	Device Size	A Waist Diameter (mm)	B LV Disc Diameter (mm)	C RV Disc Diameter (mm)	H Waist Length (mm)
SQFDQ- IV 04	04	4	9	8	3.5
SQFDQ- IV 05	05	5	10	9	3.5
SQFDQ- IV 06	06	6	11	10	4.0
SQFDQ- IV 07	07	7	12	11	4.0
SQFDQ- IV 08	08	8	13	12	4.5
SQFDQ- IV 09	09	9	14	13	5.0
SQFDQ- IV 10	10	10	17	15	5.0
SQFDQ- IV 12	12	12	20	18	5.0
SQFDQ- IV 14	14	14	22	20	5.0
SQFDQ- IV 16	16	16	24	22	5.0

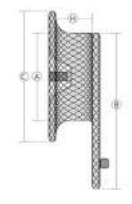
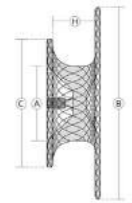
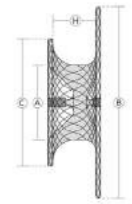

PDA Occluder



Hubless PDA Occluder

**MemoPart™**  
Patent Ductus Arteriosus (PDA) Occluder



- Modified rigidity and flexibility for different type of occluders - balanced stiffness of PDAO ensures the optimal occlusion performance.
- Uniform and smooth oxide film on nitinol wire effectively prevents from the release of nickel ion to guarantee the great biocompatibility and long-term safety.
- Hubless design helps with earlier endothelialization to minimize the risk of thrombosis.

**Ordering Information**

**Cone Shape PDA Occluder**

Catalogue No.	Device Size	B Aortic Waist Diameter (mm)	C Pulmonic Waist Diameter (mm)	A Aortic Disc Diameter (mm)	H Waist Length (mm)
WBFDDQ- II 06	0406	6	4	10	6.0
WBFDDQ- II 08	0608	8	6	12	6.5
WBFDDQ- II 10	0810	10	8	14	7.5
WBFDDQ- II 12	1012	12	10	16	8.5
WBFDDQ- II 14	1214	14	12	18	9.5
WBFDDQ- II 16	1416	16	14	20	10.5
WBFDDQ- II 18	1618	18	16	23	10.5
WBFDDQ- II 20	1820	20	18	25	12.0
WBFDDQ- II 22	2022	22	20	27	12.0

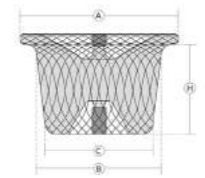

**Hubless Cone Shape PDA Occluder**

Catalogue No.	Device Size	B Aortic Waist Diameter (mm)	C Pulmonic Waist Diameter (mm)	A Aortic Disc Diameter (mm)	H Waist Length (mm)
WTWBFDDQ- II 06	0406	6	4	10	6.0
WTWBFDDQ- II 08	0608	8	6	12	6.5
WTWBFDDQ- II 10	0810	10	8	14	7.5
WTWBFDDQ- II 12	1012	12	10	16	8.5
WTWBFDDQ- II 14	1214	14	12	18	9.5
WTWBFDDQ- II 16	1416	16	14	20	10.5
WTWBFDDQ- II 18	1618	18	16	23	10.5
WTWBFDDQ- II 20	1820	20	18	25	12.0
WTWBFDDQ- II 22	2022	22	20	27	12.0

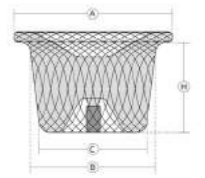

**MemoPart™**  
Patent Foramen Ovale  
(PFO) Occluder

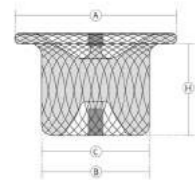

**Cylinder Shape PDA Occluder**

Catalogue No.	Device Size	B Aortic Waist Diameter (mm)	C Pulmonic Waist Diameter (mm)	A Aortic Disc Diameter (mm)	H Waist Length (mm)
WBFdq- I 04	04	4	4	8	4.0
WBFdq- I 05	05	5	5	9	5.0
WBFdq- I 06	06	6	6	10	6.0
WBFdq- I 07	07	7	7	11	6.5
WBFdq- I 08	08	8	8	12	6.5
WBFdq- I 09	09	9	9	13	7.0
WBFdq- I 10	10	10	10	14	7.5
WBFdq- I 11	11	11	11	15	8.0
WBFdq- I 12	12	12	12	16	8.5
WBFdq- I 13	13	13	13	17	8.5
WBFdq- I 14	14	14	14	18	9.5
WBFdq- I 16	16	16	16	21	10.5
WBFdq- I 18	18	18	18	23	10.5
WBFdq- I 20	20	20	20	25	12.0
WBFdq- I 22	22	22	22	27	12.0

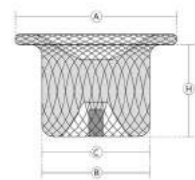

**Hubless Cylinder Shape PDA Occluder**

Catalogue No.	Device Size	B Aortic Waist Diameter (mm)	C Pulmonic Waist Diameter (mm)	A Aortic Disc Diameter (mm)	H Waist Length (mm)
WTWBFdq- I 04	04	4	4	8	4.0
WTWBFdq- I 05	05	5	5	9	5.0
WTWBFdq- I 06	06	6	6	10	6.0
WTWBFdq- I 07	07	7	7	11	6.5
WTWBFdq- I 08	08	8	8	12	6.5
WTWBFdq- I 09	09	9	9	13	7.0
WTWBFdq- I 10	10	10	10	14	7.5
WTWBFdq- I 11	11	11	11	15	8.0
WTWBFdq- I 12	12	12	12	16	8.5
WTWBFdq- I 13	13	13	13	17	8.5
WTWBFdq- I 14	14	14	14	18	9.5
WTWBFdq- I 16	16	16	16	21	10.5
WTWBFdq- I 18	18	18	18	23	10.5
WTWBFdq- I 20	20	20	20	25	12.0
WTWBFdq- I 22	22	22	22	27	12.0

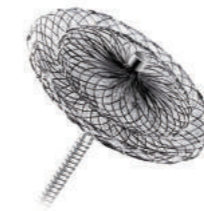

PFO Occluder



Hubless  
PFO Occluder

- Modified rigidity and flexibility for different type of occluders - greater stiffness of PFOO offers excellent supporting force for big disks.
- Uniform and smooth oxide film on nitinol wire effectively prevents from the release of nickel ion to guarantee the great biocompatibility and long-term safety.
- Optional hubless design helps with earlier endothelialization to minimize the risk of thrombosis.

**Ordering Information**

**PFO Occluder**

Catalogue No.	Device Size	C LA Disc Diameter (mm)	B RA Disc Diameter (mm)	A Waist Diameter (mm)	H Waist Length (mm)
LYKFDQ- I 1818	1818	18	18	3.5	6.0
LYKFDQ- I 1824	1824	18	24	4.0	7.0
LYKFDQ- I 2424	2424	24	24	4.0	7.0
LYKFDQ- I 2228	2228	22	28	4.5	7.0
LYKFDQ- I 2828	2828	28	28	4.5	7.0
LYKFDQ- I 2534	2534	25	34	5.0	7.0
LYKFDQ- I 3434	3434	34	34	5.0	7.0

**Hubless PFO Occluder**

Catalogue No.	Device Size	C LA Disc Diameter (mm)	B RA Disc Diameter (mm)	A Waist Diameter (mm)	H Waist Length (mm)
WTLYKFDQ- I 1818	1818	18	18	3.5	6.0
WTLYKFDQ- I 1824	1824	18	24	4.0	7.0
WTLYKFDQ- I 2424	2424	24	24	4.0	7.0
WTLYKFDQ- I 2228	2228	22	28	4.5	7.0
WTLYKFDQ- I 2828	2828	28	28	4.5	7.0
WTLYKFDQ- I 2534	2534	25	34	5.0	7.0
WTLYKFDQ- I 3434	3434	34	34	5.0	7.0

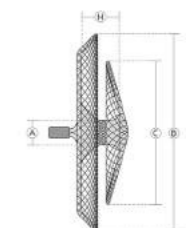
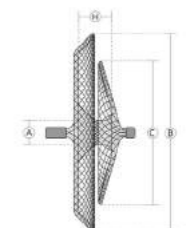

# MemoPart™

## Plug

CE



Vascular Plug



Hubless Vascular Plug

MemoPart™ Plug is a percutaneous, transcatheter device applied to the closure of a wide variety of veins and arteries, reducing or eliminating blood flow by blocking the target vessel. The vascular plug can be used for the patients with clinical symptoms of abnormal blood vessels, such as:

- Aortopulmonary collaterals
- Arteriovenous malformation
- Surgical aortopulmonary shunts
- Anomalous venovenous connections
- Arteriovenous fistulas
- Peripheral vessels

### Ordering Information

#### Vascular Plug

Catalogue No.	Device Size	A Waist Diameter (mm)	B Waist Length (mm)
XGSFDQ- I 04	04	4	5.0
XGSFDQ- I 06	06	6	6.5
XGSFDQ- I 08	08	8	7.5
XGSFDQ- I 10	10	10	8.5
XGSFDQ- I 12	12	12	9.5
XGSFDQ- I 14	14	14	10.5
XGSFDQ- I 16	16	16	11.0
XGSFDQ- I 18	18	18	11.0
XGSFDQ- I 20	20	20	12.0
XGSFDQ- I 22	22	22	13.0

#### Hubless Vascular Plug

Catalogue No.	Device Size	A Waist Diameter (mm)	B Waist Length (mm)
WTXGSFDQ- I 04	04	4	5.0
WTXGSFDQ- I 06	06	6	6.5
WTXGSFDQ- I 08	08	8	7.5
WTXGSFDQ- I 10	10	10	8.5
WTXGSFDQ- I 12	12	12	9.5
WTXGSFDQ- I 14	14	14	10.5
WTXGSFDQ- I 16	16	16	11.0
WTXGSFDQ- I 18	18	18	11.0
WTXGSFDQ- I 20	20	20	12.0
WTXGSFDQ- I 22	22	22	13.0

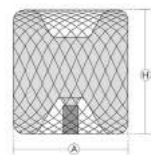

# MemoPart™

## Occluder Delivery System

CE

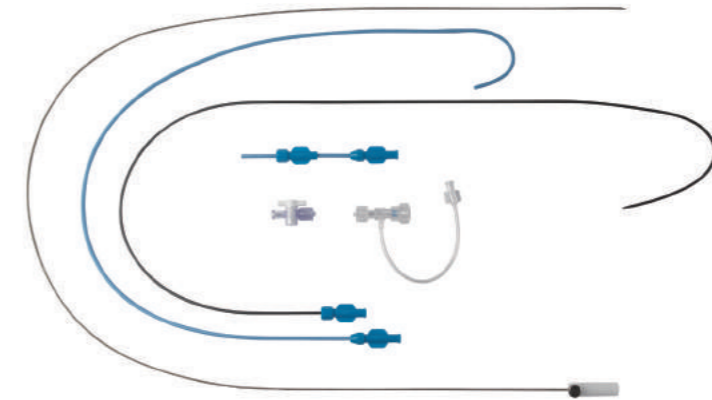

- Two different lengths of the sheath for adults and children.
- Anti-kink delivery system is also available for VSD occluders.

### The delivery system includes:

- Loader (1)
- Long Sheath (1)
- Dilator (1)
- Pusher (1)
- Y-connector with tubing (1)

### Ordering Information

#### Delivery System for Adult ASD and PFO Occluders

Catalogue No.	Loader		Long sheath			Dilator Effective Length (mm)	Pusher	
	I.D. (mm)	Effective Length (mm)	I.D. (mm)	Effective Length (mm)	Angle		Effective Length (mm)	Diameter (mm)
ODS-A-I-5F	5F/1.85	130	5F/1.85	800	45°	920	1200	1.4
ODS-A-I-6F	6F/2.0	130	6F/2.0	800	45°	920	1200	1.6
ODS-A-I-7F	7F/2.33	130	7F/2.33	800	45°	920	1200	1.8
ODS-A-I-8F	8F/2.67	130	8F/2.67	800	45°	920	1200	1.8
ODS-A-I-9F	9F/3.0	130	9F/3.0	800	45°	920	1200	1.8
ODS-A-I-10F	10F/3.33	130	10F/3.33	800	45°	920	1200	1.9
ODS-A-I-12F	12F/4.0	160	12F/4.0	800	45°	920	1200	2.0
ODS-A-I-14F	14F/4.67	160	14F/4.67	800	45°	920	1200	2.0

## MemoPart™

Snare

CE



### Delivery System for Adult VSD, PDA Occluders and Plug

Catalogue No.	Loader		Long sheath			Dilator	Pusher	
	I.D. (mm)	Effective Length (mm)	I.D. (mm)	Effective Length (mm)	Angle	Effective Length (mm)	Effective Length (mm)	Diameter (mm)
ODS-P/V-II-5F	5F/1.85	130	5F/1.85	800	180°	920	1200	1.4
ODS-P/V-II-6F	6F/2.0	130	6F/2.0	800	180°	920	1200	1.6
ODS-P/V-II-7F	7F/2.33	130	7F/2.33	800	180°	920	1200	1.8
ODS-P/V-II-8F	8F/2.67	130	8F/2.67	800	180°	920	1200	1.8
ODS-P/V-II-9F	9F/3.0	130	9F/3.0	800	180°	920	1200	1.8
ODS-P/V-II-10F	10F/3.33	130	10F/3.33	800	180°	920	1200	1.9
ODS-P/V-II-12F	12F/4.0	160	12F/4.0	800	180°	920	1200	2.0
ODS-P/V-II-14F	14F/4.67	160	14F/4.67	800	180°	920	1200	2.0

### Delivery System for Children ASD and PFO Occluders

Catalogue No.	Loader		Long sheath			Dilator	Pusher	
	I.D. (mm)	Effective Length (mm)	I.D. (mm)	Effective Length (mm)	Angle	Effective Length (mm)	Effective Length (mm)	Diameter (mm)
ODS-A-III-5F	5F/1.85	130	5F/1.85	600	45°	680	1200	1.4
ODS-A-III-6F	6F/2.0	130	6F/2.0	600	45°	680	1200	1.6
ODS-A-III-7F	7F/2.33	130	7F/2.33	600	45°	680	1200	1.8
ODS-A-III-8F	8F/2.67	130	8F/2.67	600	45°	680	1200	1.8
ODS-A-III-9F	9F/3.0	130	9F/3.0	600	45°	680	1200	1.8
ODS-A-III-10F	10F/3.33	130	10F/3.33	600	45°	680	1200	1.9
ODS-A-III-12F	12F/4.0	160	12F/4.0	600	45°	680	1200	2.0
ODS-A-III-14F	14F/4.67	160	14F/4.67	600	45°	680	1200	2.0

### Delivery System for Children VSD, PDA Occluders and Plug

Catalogue No.	Loader		Long sheath			Dilator	Pusher	
	I.D. (mm)	Effective Length (mm)	I.D. (mm)	Effective Length (mm)	Angle	Effective Length (mm)	Effective Length (mm)	Diameter (mm)
ODS-P/V-IV-5F	5F/1.85	130	5F/1.85	600	180°	680	1200	1.4
ODS-P/V-IV-6F	6F/2.0	130	6F/2.0	600	180°	680	1200	1.6
ODS-P/V-IV-7F	7F/2.33	130	7F/2.33	600	180°	680	1200	1.8
ODS-P/V-IV-8F	8F/2.67	130	8F/2.67	600	180°	680	1200	1.8
ODS-P/V-IV-9F	9F/3.0	130	9F/3.0	600	180°	680	1200	1.8
ODS-P/V-IV-10F	10F/3.33	130	10F/3.33	600	180°	680	1200	1.9
ODS-P/V-IV-12F	12F/4.0	160	12F/4.0	600	180°	680	1200	2.0
ODS-P/V-IV-14F	14F/4.67	160	14F/4.67	600	180°	680	1200	2.0

MemoPart™ Snare is composed by Nitinol coated Tungsten coil and the Nitinol shaft, which provides great radiopacity, biocompatibility and shape memory ability. This is a widely used device to:

- Establish the femoral artery-vein loop
- Retrieve the dislocated occluder
- Retrieve stent or guide wire
- Retrieve the blood filter
- Help with control navigation, etc.

#### Ordering Information

Catalogue No.	Effective Length (mm)	Diameter of Snare Circle (mm)	Angle
Snare-15	1240	15	90°
Snare-20	1240	20	90°



## GK-3 Single-leaflet Prosthetic Heart Valve



### Improved Design—excellent efficacy

- Large orifice-to-annulus ratio
- Low transvalvular pressure gradient
- Large opening angles - 75° for the aortic valve, and 70° for the mitral valve

### Advanced Material—high performance, superior safety

- Leaflet material: Pyrolytic carbon
- Ring material: Titanium (machined from a single block)
- Sewing ring material: Polyester PET

### Ordering Information

Aortic Valves				
Catalogue No.	Tissue Annulus Diameter (mm)	Orifice Inner Diameter (mm)	Geometric Orifice Area (cm <sup>2</sup> )	Opening Angle
GK-3 20A	20	16	1.94	75°
GK-3 21A	21	16	1.94	75°
GK-3 23A	23	18	2.43	75°
GK-3 25A	25	20	3.02	75°
GK-3 27A	27	22	3.71	70°

Mitral Valves				
Catalogue No.	Tissue Annulus Diameter (mm)	Orifice Inner Diameter (mm)	Geometric Orifice Area (cm <sup>2</sup> )	Opening Angle
GK-3 23M	31	18	2.43	70°
GK-3 25M	33	20	3.02	70°
GK-3 27M	35	22	3.71	70°
GK-3 29M	37	24	4.4	70°
GK-3 31M	39	24	4.4	70°

Notice: Please contact the sales for detailed information before placing the order.

## GKS Bi-leaflet Prosthetic Heart Valve



### High Performance Material

- The leaflets and hinge ring are made by pyrolytic carbon, which guarantees the excellent biocompatibility and superior safety.

### Open Pivot Design

- Open pivot design ensures the sufficient blood washing to reduce the risk of thrombosis.
- This design reduces the shear stress that acts on the blood cells to minimize the damage.

### 85° Leaflet Opening

- The 85° leaflet opening provides improved laminar flow, reduces the turbulence, and optimizes the transvalvular gradients.

### Suspending Leaflets

- Suspending leaflets design enables the fast open and close to guarantee the physiological needs.

### Lower Noise

- Smooth buffering reduces the noise when the leaflets open and close, providing quieter impact for better life.

### Ordering Information

Aortic Valves					
	Catalogue No.	Tissue Annulus Diameter (mm)	Orifice Inner Diameter (mm)	Geometric Orifice Area (cm <sup>2</sup> )	Opening Angle
Standard Model - Intra Annular	GKS 19A	19.8	14.8	1.55	85°
	GKS 21A	21.8	16.8	2.02	85°
	GKS 23A	23.8	18.8	2.56	85°
	GKS 25A	25.8	20.8	3.17	85°
	GKS 27A	27.8	22.8	3.84	85°
Advanced Performance Model - Supra Annular	GKS 16AP	16.2	14.8	1.55	85°
	GKS 18AP	18.2	16.8	2.02	85°
	GKS 20AP	20.2	18.8	2.56	85°

Mitral Valves				
Catalogue No.	Tissue Annulus Diameter (mm)	Orifice Inner Diameter (mm)	Geometric Orifice Area (cm <sup>2</sup> )	Opening Angle
GKS 23M	23.8	18.8	2.56	85°
GKS 25M	25.8	20.8	3.17	85°
GKS 27M	27.8	22.8	3.84	85°
GKS 29M	29.8	24.8	4.59	85°
GKS 31M	31.8	26.8	5.37	85°
GKS 33M	33.8	26.8	5.37	85°

# 05 / Surgical Cardiology Products

OPCABG

## Disposable Tissue Stabilizer



62 Off-pump Coronary Artery Bypass Grafting  
Disposable Tissue stabilizer

### Indication

Apply to off-pump coronary artery bypass graft (OPCABG), help with fixing the heart to minimize the influence of the surgery that caused by heart beating.

- Easy to set up
- Free to turn 360°
- Excellent flexibility and reliable stabilization
- Compatible with most of the sternal retractor in the market

### Ordering Information

Catalogue No.	Application
SDTS001	Attached to pericardial tissue
SDTS002	Attached to heart apex

Notice: Please contact the sales for detailed information before placing the order.

# 06

## Cardiac Rhythm Management Products



### Electrophysiology Products

- 65 Eel Cath™ Electrophysiology Diagnostic Catheter CE
- 66 Eel Cath™ Circular Mapping Diagnostic Catheter for Pulmonary Vein CE
- 67 Eel Cath™ Electrophysiology Ablation Catheter CE
- 68 Eel Cath™ Electrophysiology Catheter Cable CE

### Pacemakers and Leads

- 69 Implantable Single Chamber Pacemaker
- 70 Implantable Dual Chamber Pacemaker
- 71 Bipolar Passive Fixation Lead
- 72 Bipolar Active Fixation Lead

### Equipment

- 73 Dual Chamber Pacing System Programmer
- 74 Dual Chamber Pacing System Analyzer

# Eel Cath™

Electrophysiology  
Diagnostic Catheter

CE

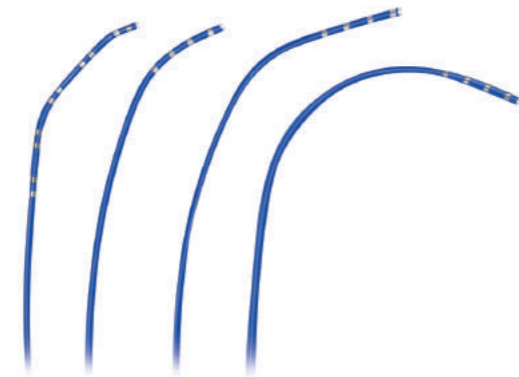

- Fixed curve design, multiple curve types can satisfy the diagnostic needs in different body positions.
- Steady attached to the collection position, shorten operation time and reduce X-ray exposure.
- 1:1 torque transition for easy pushability and accurate placement.
- Soft and transparent tip design minimizes the damage to heart.
- Platinum electrodes ensure good conduction and signal.
- Good visibility

### Ordering Information

Catalogue No.	Catheter O.D.	Tip Curve	Application	Distal Tip Type	Number of Electrodes	Catheter Length (cm)	Electrode Spacing (mm)													
LP10F6J4(5)	6F	J	HRA	Soft Tip	4	115	5													
LP10F6J4(252)							2-5-2													
LP10F6J4(10)							10													
LP10F6J4(282)							2-8-2													
LP10F6C4(5)							C		HIS	Soft Tip	4	115	5							
LP10F6C4(252)													2-5-2							
LP10F6C4(10)													10							
LP10F6C4(282)													2-8-2							
LP10F6D4(5)													D		RVA	Soft Tip	4	115	5	
LP10F6D4(252)																			2-5-2	
LP10F6D4(10)							10													
LP10F6D4(282)							2-8-2													
LP10F6J4(5)P		J	HRA	Platinum Tip	4	115	5													
LP10F6J4(252)P							2-5-2													
LP10F6J4(10)P							10													
LP10F6J4(282)P							2-8-2													
LP10F6C4(5)P							C		HIS	Platinum Tip	4	115	5							
LP10F6C4(252)P													2-5-2							
LP10F6C4(10)P													10							
LP10F6C4(282)P													2-8-2							
LP10F6D4(5)P													D		RVA	Platinum Tip	4	115	5	
LP10F6D4(252)P																			2-5-2	
LP10F6D4(10)P							10													
LP10F6D4(282)P							2-8-2													
LP10F6J7(252)		J	HRA	Soft Tip	7	115	2-5-2													
LP10F6J7(252)P				Platinum Tip			2-5-2													
LP10F6P10(282)1		P	CS	Soft Tip	10	115	2-8-2													
LP10F6P10(282)2						90	2-8-2													
LP10F6P10(282)3						60	2-8-2													

Notice: Please contact the sales for detailed information before placing the order.

# Eel Cath™

Circular Mapping  
Diagnostic Catheter  
for Pulmonary Vein

CE



- 180° deflectable distal tip.
- Steady curve configurations.
- Bigger contact area, providing optimal visualization.
- The circular electrode is polished to be smooth and flat.
- Records electrograms simultaneously inside the circumferential region.
- Multiple loop diameters for easy placement, suitable for variety anatomical structure.

### Ordering Information

Catalogue No.	Catheter O.D.	Number of Electrodes	Catheter Length (cm)	Diameter of Circular Tip (mm)	Electrode Spacing (mm)	Width of Electrodes (mm)
LP30F7L10(4.5)15(0.65)	7F	10	115	15	4.5	0.65mm (1mm for the first one)
LP30F7L10(4.5)15(1)					4.5	1mm
LP30F7L10(6)20(0.65)				20	6	0.65mm (1mm for the first one)
LP30F7L10(6)20(1)					6	1mm
LP30F7L10(8)25(0.65)				25	8	0.65mm (1mm for the first one)
LP30F7L10(8)25(1)					8	1mm

Notice: Please contact the sales for detailed information before placing the order.

## Eel Cath™

Electrophysiology  
Ablation Catheter

CE

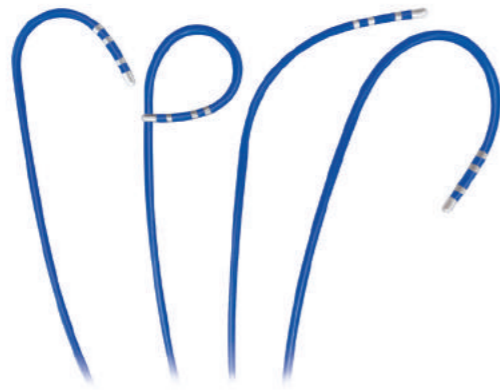

- Good pushability and torque control for easy placement.
- High-precision temperature transducer guarantees the accurate temperature reflection of the electrodes during operation, minimizing damage for cardiac muscle cells.
- Variety of curves and configurations are available.
- Compatible with most available RF generators in the market.

### Ordering Information

Catalogue No.	Catheter O.D.	Tip Curve	Number of Electrodes	Catheter Length (cm)	Temperature Sensor	Electrode Spacing (mm)	Catheter Hardness
LP207A4(252)4TC	7F	A	4	115	TC	2-5-2	Normal
LP207B4(252)4TC		B					
LP207C4(252)4TC		C					
LP207D4(252)4TC		D					
LP207A4(252)4THR		A			THR		
LP207B4(252)4THR		B					
LP207C4(252)4THR		C					
LP207D4(252)4THR		D					
LP20H7A4(252)4TC		A	4	115	TC	2-5-2	Induration
LP20H7B4(252)4TC		B					
LP20H7C4(252)4TC		C					
LP20H7D4(252)4TC		D					
LP20H7A4(252)4THR		A			THR		
LP20H7B4(252)4THR		B					
LP20H7C4(252)4THR		C					
LP20H7D4(252)4THR		D					

Notice: Please contact the sales for detailed information before placing the order.

## Eel Cath™

Electrophysiology  
Catheter Cable

CE



- Redel proximal connector
- Suitable for different temperature controlled catheters.
- Different colors for each distal connecting line, convenient for use.
- Compatible for Johnson & Johnson's catheter and equipment, as well as St. Jude's equipment.

### Ordering Information

Diagnostic Catheter Cable				
Catalogue No.	Cable Diameter (mm)	Cable Length (cm)	Output Terminal Cable Diameter (mm)	Number of Output Terminals
LPEPC(0104)	6.2	200	3	4
LPEPC(0110)	6.2	200	2	10
LPEPC(0112)	6.2	200	2	12

Ablation Catheter Cable			
Catalogue No.	Cable Diameter (mm)	Cable Length (cm)	Number of Output Terminals
LPEPC(0210)	4.5	250	10
LPEPC(0214)	4.5	250	14

Notice: Please contact the sales for detailed information before placing the order.

## Implantable Single Chamber Pacemaker



- Patent technology of RF power supply provides safe program control without consuming the battery power.
- 9 technical parameters contribute to the accuracy of stored program control.
- Events counter and program control tests are convenient.
- Multiple protections effectively avoid the interference.
- Ergonomic design with small size, light weight and long lifetime.
- Compatible with the major programmers in the market.

### Specifications

Connector	IS-1
Size	48.5mm x 41mm x 6mm
Weight	20.8g
Volume	8.8cm <sup>3</sup>
Battery	1.0Ah, 2.8V
Battery Lifetime	10.2years (100% pace-making)

### Technical Parameters

Parameter	Range
Pacing Mode	<b>SSI/SST/SOO</b>
Basic Rate (ppm)	30...(1)... <b>60</b> ...(1)...100...(10)...160
Max. Rate Limitation (ppm)	180
Pulse Amplitude (V)	0.1...(0.1)... <b>3.8</b> ...(0.1)...8.1
Pulse Width (ms)	0.06...(0.06)...0.18, 0.25...(0.06)... <b>0.37</b> ...(0.06)...0.79, 0.86...(0.06)...1.40, 1.47...(0.06)...1.59
Sensing Sensitivity (mV)	0.5...(0.5)... <b>2.5</b> ...(0.5)...10.0
Refractory Period (ms)	200...(25)... <b>325</b> ...(25)...500
Hysteresis (ms)	<b>0</b> ...(50)...350
Pacing Polarity	<b>Unipolar/Bipolar</b>
Sensing Polarity	<b>Unipolar/Bipolar</b>

Note: Bold parameters are factory settings.

### Ordering Information

Catalogue No.	2312M
---------------	-------

Notice: Please contact the sales for detailed information before placing the order.

## Implantable Dual Chamber Pacemaker



- Chinese first dual-chamber pacemaker series with independent intellectual property.
- Patent technology of RF power supply provides safe program control without consuming the battery power.
- New generation programmer provides accurate control of the parameters.
- Imported lithium-iodine battery ensures the durable lifetime.
- Optimized ergonomic design makes it comfortable after implantation.
- Multiple protections effectively avoid the interference to guarantee the patients safety.

### Technical Parameters

Parameter	Range
Pacing Mode	<b>DDD(R)/VDD(R)/DDI(R)/DVI(R)/DOO(R)/AAI(R)/AAT(R)/AOO(R)/VVI(R)/VVT(R)/VOO(R)</b>
Basic Rate (ppm)	30...(1)... <b>60</b> ...(1)...100...(10)...180
Ventricular Pulse Amplitude (V)	0.1...(0.1)... <b>3.6</b> ...(0.1)...8.1
Ventricular Pulse Width (ms)	0.06...(0.06)...0.24, 0.31...(0.06)... <b>0.37</b> ...(0.06)...0.85, 0.92...(0.06)...1.46, 1.53
Ventricular Sensing Sensitivity (mV)	0.5...(0.5)... <b>2.5</b> ...(0.5)...10.0
Ventricular Refractory Period (ms)	150...(25)... <b>250</b> ...(25)...500
Hysteresis (ms)	<b>0</b> ...(50)...350
Ventricular Pacing Polarity	<b>Unipolar/Bipolar</b>
Ventricular Sensing Polarity	<b>Unipolar/Bipolar</b>
Atrial Pulse Amplitude (V)	0.1...(0.1)... <b>3.6</b> ...(0.1)...8.1
Atrial Pulse Width (ms)	0.06...(0.06)...0.24, 0.31...(0.06)... <b>0.37</b> ...(0.06)...0.85, 0.92...(0.06)...1.46, 1.53
Atrial Sensing Sensitivity (mV)	0.25...(0.25)... <b>1.0</b> ...(0.25)...5.0
Postventricular Atrial Refractory Period (PVARP) (ms)	150...(25)... <b>250</b> ...(25)...500
AV Period (ms)	30...(10)... <b>180</b> ...(10)...350
Atrial Refractory Period Extended (ms)	<b>0</b> ...(25)...350
Sensor	Accelerometer

Note: Bold parameters are factory settings.

### Ordering Information

Catalogue No.	8631DR	8631D
---------------	--------	-------

Notice: Please contact the sales for detailed information before placing the order.

## Bipolar Passive Fixation Lead

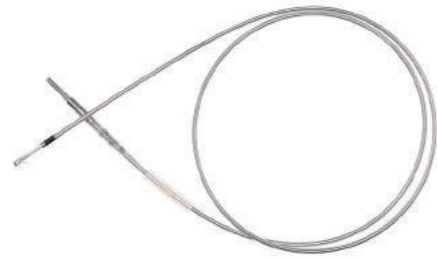

### Technical Parameters

Lead Type	Bipolar, Passive fixation, Drug releasing
Drug Containing	Dexamethasone sodium phosphate (0.75mg)
Application	Ventricle / Atrium
Lead Connector	IS-1 BI
Length	45cm / 53cm / 60cm
Diameter	1.9mm
Minimum Introducer Compatibility	7F
Tip Electrode Surface Area	3.4mm <sup>2</sup>
Electrode Space	13mm
Electrode Material (Cathode)	Pt-Ir
Conductor Material	MP35N
Insulator Material	Medical silicone rubber

### Ordering Information

Catalogue No.	Length (cm)	Lead Type	Application
7231-45	45	Passive	Ventricle
7231-53	53		
7231-60	60		
7222-45	45	Passive	Atrium
7222-53	53		
7222-60	60		

Notice: Please contact the sales for detailed information before placing the order.

## Bipolar Active Fixation Lead

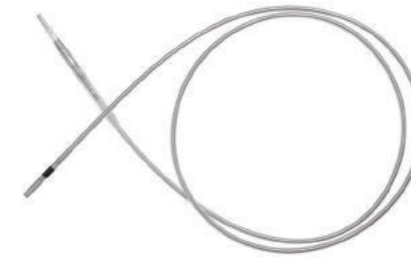

### Technical Parameters

Lead Type	Bipolar, Active fixation, Drug releasing
Drug Containing	Dexamethasone sodium phosphate (0.75mg)
Application	Ventricle
Lead Connector	IS-1 BI
Length	45cm / 53cm / 60cm
Diameter	2.1mm
Minimum Introducer Compatibility	7F
Tip Electrode Surface Area	6.8mm <sup>2</sup>
Electrode Space	10mm
Electrode Material (Cathode)	Pt-Ir
Conductor Material	MP35N
Insulator Material	Medical silicone rubber

### Ordering Information

Catalogue No.	Length (cm)	Lead Type	Application
7211-45	45	Active	Ventricle
7211-53	53		
7211-60	60		

Notice: Please contact the sales for detailed information before placing the order.

## Dual Chamber Pacing System Programmer



- 12" LCD touch screen
- User-friendly UI design
- Display of intracardiac electrogram
- Scroll display of electrocardiosignal
- Storage of follow-up data

### Ordering Information

Catalogue No.	QM8631
---------------	--------

Notice: Please contact the sales for detailed information before placing the order.

## Dual Chamber Pacing System Analyzer



### Pacing System Analysis

- 10 types of testing modes
- One-key test design
- High precision of pacing threshold testing
- Exact adjustments of pacing parameters
- Real-time ECG

### Pacemaker Testing

- One-key test of pacemaker basic parameters
- Global waveforms of sensitivity test

**Built-in printer, self-check and self-test are available**

### Technical Parameters

Parameter	Range	Step
Basic Rate (ppm)	31-180 (Dual chamber 31-90)	1
Pacing Interval (ms)	333-1935 (Dual chamber 667-1935)	1
Max. Rate Limitation (ppm)	100-180 (Only for dual chamber DDD/VDD)	1
Pulse Amplitude (V)	0.10-10.0	0.1
Pulse Width (ms)	0.05-2.50	0.01
Sensing Sensitivity (mV)	0.5-10.0	0.25
Refractory Period (ms)	200-500	25
A-V Interval (ms)	50-300 (Only for dual chamber pacing mode)	1
Hysteresis (ms)	0-400	1
Quick Stimulate Rate (ppm)	31-800 (Dual chamber 31-350)	1
Pacing Mode	VVI/VVT/VOO/AAI/AAT AOO/DDD/DVI/DOO/VDD	/

### Ordering Information

Catalogue No.	QM2352A
---------------	---------

Notice: Please contact the sales for detailed information before placing the order.



# 07 Critical Care Products

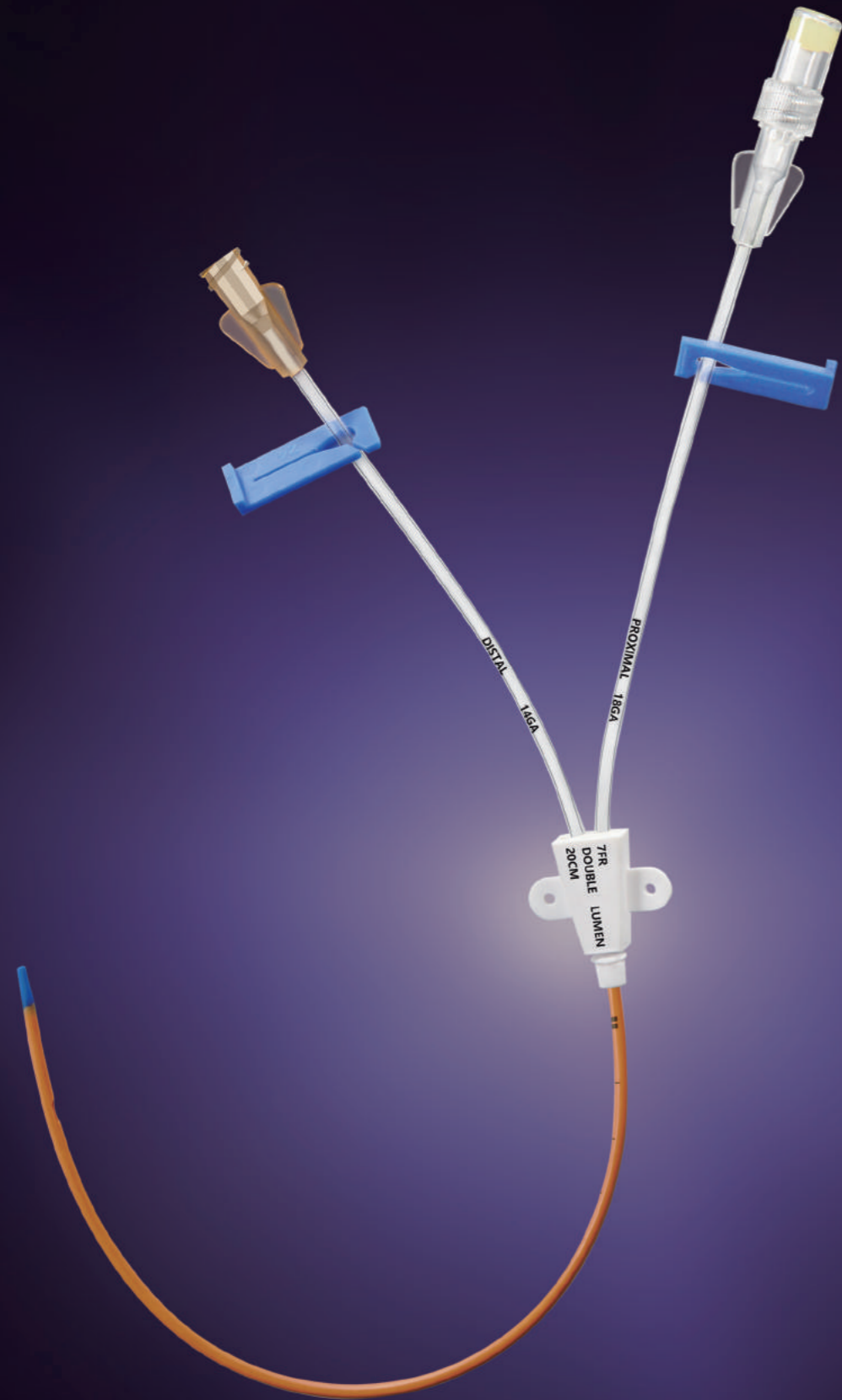

## IV Catheters

- 77 Safecath™ Disposable Central Venous Catheter Kit **CE**
- 79 Antimicrobial Central Venous Catheter Kit

## Needle-free Connectors

- 81 Needle-free Connectors **CE**

## Blood Sampler

- 83 Disposable Arterial Blood Sampler

## Pressure Transducer

- 84 Disposable Blood Pressure Transducer **CE**

## Safecath™

### Disposable Central Venous Catheter Kit

CE



- The latex-free material provides excellent safety.
- Excellent radiopacity of the catheter makes it easier and safer for operation.
- Soft blue tip provides less harm to the vessel, makes it easier to enter into the puncture point.
- The patented design of the connector makes it smooth and firm, effectively prevent the product from infection, leakage and shedding.
- The transparent extension tubes with detachable clamps and printed marks allow to maintain the catheter away from the insertion site, reduce the risk of air embolism.
- Standard package and full package of the CVC Kit are available.

#### Standard Package:

Central Venous Catheter (1)  
Guide Wire (1)  
Tissue Dilator (1)  
Scalpel (1)  
Introducer Needle / Y-Shape Needle (1)  
Blue Introducer Syringe (1/0)  
Syringe with Needle (1/2)  
Heparin Cap (1/2/3)  
Catheter Fastener (1)  
Extension Line Clamp (1/2/3)

#### Full Package:

Central Venous Catheter (1)  
Guide Wire (1)  
Tissue Dilator (1)  
Scalpel (1)  
Introducer Needle / Y-Shape Needle (1)  
Blue Introducer Syringe (1/0)  
Syringe with Needle (1/2)  
Heparin Cap (1/2/3)  
Catheter Fastener (1)  
Extension Line Clamp (1/2/3)  
Gauze Pad (2)  
Prep Sponge Swab (3)  
Applicator case (2)  
Silk Suture with Straight and Bended Needles (2)  
Wound Closure Strip (1)  
Dressings (1)  
Fenestrated Drape (1)  
Small Drape (1)  
Middle Drape (1)  
Gloves (1)



#### Ordering Information

Central Venous Catheter			
Catalogue No.	Lumen Type	Catheter Size	Catheter Length (cm)
MMCVCBJ1-14-15	Single-lumen	14G	15
MMCVCBJ1-14-20	Single-lumen	14G	20
MMCVCBJ1-14-30	Single-lumen	14G	30
MMCVCBJ1-16-15	Single-lumen	16G	15
MMCVCBJ1-16-20	Single-lumen	16G	20
MMCVCBJ1-16-30	Single-lumen	16G	30
MMCVCBJ1-18-15	Single-lumen	18G	15
MMCVCBJ1-18-20	Single-lumen	18G	20
MMCVCBJ1-18-30	Single-lumen	18G	30
MMCVCBJ1-20-13	Single-lumen	20G	13
MMCVCBJ1-20-20	Single-lumen	20G	20
MMCVCBJ2-40-05	Double-lumen	4F	5
MMCVCBJ2-40-08	Double-lumen	4F	8
MMCVCBJ2-40-13	Double-lumen	4F	13
MMCVCBJ2-50-08	Double-lumen	5F	8
MMCVCBJ2-50-13	Double-lumen	5F	13
MMCVCBJ2-50-20	Double-lumen	5F	20
MMCVCBJ2-70-15	Double-lumen	7F	15
MMCVCBJ2-70-20	Double-lumen	7F	20
MMCVCBJ2-70-30	Double-lumen	7F	30
MMCVCBJ2-70-50	Double-lumen	7F	50
MMCVCBJ3-55-08	Triple-lumen	5.5F	8
MMCVCBJ3-55-13	Triple-lumen	5.5F	13
MMCVCBJ3-70-15	Triple-lumen	7F	15
MMCVCBJ3-70-20	Triple-lumen	7F	20
MMCVCBJ3-70-30	Triple-lumen	7F	30

#### Hemodialysis Catheter\*

Catalogue No.	Lumen Type	Catheter Size	Catheter Length (cm)
MMCVCBJ2-115-13	Double-lumen	11.5F	13
MMCVCBJ2-115-16	Double-lumen	11.5F	16
MMCVCBJ2-115-20	Double-lumen	11.5F	20

#### Peripheral Inserted Central Catheter\*

Catalogue No.	Lumen Type	Catheter Size	Catheter Length (cm)
MMCVCBJ1-40-45	Single-lumen	4F	45
MMCVCBJ1-40-60	Single-lumen	4F	60
MMCVCBJ1-50-45	Single-lumen	5F	45
MMCVCBJ1-50-60	Single-lumen	5F	60

\* Notice: More specifications are available for Hemodialysis Catheter and Peripheral Inserted Central Catheter. Please contact the sales for detailed information before placing the order.



## Antimicrobial Central Venous Catheter Kit

### Safecath Plus



- Antimicrobial coating of Minocycline and Rifampicin effectively prevents the catheter related bloodstream infection (CRBSI).
- Gradually released drug coating after implantation guarantees the durable and reliable antibacterial performance.
- Standard package and full package of the antimicrobial CVC Kit are available.

#### Standard Package:

Antimicrobial Central Venous Catheter (1)  
Guide Wire (1)  
Tissue Dilator (1)  
Scalpel (1)  
Introducer Needle / Y-Shape Needle (1)  
Blue Introducer Syringe (1/0)  
Syringe with Needle (1/2)  
Heparin Cap (1/2/3)  
Catheter Fastener (1)  
Extension Line Clamp (1/2/3)

#### Full Package:

Antimicrobial Central Venous Catheter (1)  
Guide Wire (1)  
Tissue Dilator (1)  
Scalpel (1)  
Introducer Needle / Y-Shape Needle (1)  
Blue Introducer Syringe (1/0)  
Syringe with Needle (1/2)  
Heparin Cap (1/2/3)  
Catheter Fastener (1)  
Extension Line Clamp (1/2/3)  
Gauze Pad (2)  
Prep Sponge Swab (3)  
Applicator case (2)  
Silk Suture with Straight and Bended Needles (2)  
Wound Closure Strip (1)  
Dressings (1)  
Fenestrated Drape (1)  
Small Drape (1)  
Middle Drape (1)  
Gloves (1)



#### Ordering Information

Catalogue No.	Lumen Type	Catheter Size	Catheter Length (cm)
LPPCVC1-14-15	Single-lumen	14G	15
LPPCVC1-14-20	Single-lumen	14G	20
LPPCVC1-14-30	Single-lumen	14G	30
LPPCVC1-16-15	Single-lumen	16G	15
LPPCVC1-16-20	Single-lumen	16G	20
LPPCVC1-16-30	Single-lumen	16G	30
LPPCVC1-18-15	Single-lumen	18G	15
LPPCVC1-18-20	Single-lumen	18G	20
LPPCVC1-18-30	Single-lumen	18G	30
LPPCVC1-20-13	Single-lumen	20G	13
LPPCVC1-20-20	Single-lumen	20G	20
LPPCVC2-40-05	Double-lumen	4F	5
LPPCVC2-40-08	Double-lumen	4F	8
LPPCVC2-40-13	Double-lumen	4F	13
LPPCVC2-50-05	Double-lumen	5F	5
LPPCVC2-50-08	Double-lumen	5F	8
LPPCVC2-50-13	Double-lumen	5F	13
LPPCVC2-50-20	Double-lumen	5F	20
LPPCVC2-70-15	Double-lumen	7F	15
LPPCVC2-70-20	Double-lumen	7F	20
LPPCVC2-70-30	Double-lumen	7F	30
LPPCVC2-70-50	Double-lumen	7F	50
LPPCVC3-55-08	Triple-lumen	5.5F	8
LPPCVC3-55-13	Triple-lumen	5.5F	13
LPPCVC3-70-15	Triple-lumen	7F	15
LPPCVC3-70-20	Triple-lumen	7F	20
LPPCVC3-70-30	Triple-lumen	7F	30

#### Hemodialysis Catheter

Catalogue No.	Lumen Type	Catheter Size	Catheter Length (cm)
LPPCVC2-115-15	Double-lumen	11.5F	15
LPPCVC2-115-20	Double-lumen	11.5F	20

Notice: Please contact the sales for detailed information before placing the order.

## Needle-free Connectors

CE



- Metal-free design ensures the compatibility of MRI.
- The smooth and flat top can be effectively sterilized, inhibiting the growth of bacteria.
- Small dead space ensures the accuracy of drug dosage, avoiding the waste of expensive drugs.
- The positive pressure design effectively prevents the blood reflux, and avoids clotting inside the tube.
- This connector is available for all kinds of standard medical accessories.

### Technical Parameters

Average Flow Rate	240 - 250mL/min
Average Positive Pressure Volume	0.05mL
Dead Space Volume	< 0.2mL

### Ordering information

Catalogue No.	Positive Pressure or Not	Extension Tubing Length (cm)
LP-JZ-10	Yes	/
LP-JZ-10X	Yes	20



- Tiny size, easy to be fixed, and convenient to manipulate.
- The whole connector is made of antibacterial material, which ensures the inner aseptic condition, inhibits the growth of bacteria, and avoids the infection effectively.
- Small dead space ensures the accuracy of drug dosage, avoiding the waste of expensive drugs.
- The positive pressure design effectively prevents the blood reflux, and avoids clotting inside the tube.
- This connector is available for all kinds of standard medical accessories.

### Technical Parameters

Average Flow Rate	120 - 180mL/min
Average Positive Pressure Volume	0.05mL
Dead Space Volume	< 0.06mL

### Ordering information

Catalogue No.	Positive Pressure or Not	Extension Tubing Length (cm)
LP-JZ-11	Yes	/
LP-JZ-11X	Yes	20

- High flow rate. Maximum flow rate reaches up to 540mL/min. It enable to transfer high viscosity nutrient solution and blood products with higher flow rate.
- Excellent safety. Split-septum design guarantees no air gap at the edges of the split-septum Luer access, which allows the seamless joint with syringe to reduce infection.
- Effective drug delivery. The zero dead space and straight fluid channel avoid the residual blood and drug.
- Better visibility. Transparent design and tiny size make it easy to manipulate.
- Multi-function. This access can be applied to blood sampling.

### Ordering information

Catalogue No.	Positive Pressure or Not	Extension Tubing Length (cm)
LP-JP-11	No	/
LP-JP-11X	No	20



## Disposable Arterial Blood Sampler



### Standard Type

- Two sampling methods: Preset Type / Pumping Type
- The syringe plunger is made of anti-tear, high-elastic ventilated silicon membrane, which ensures its excellent sliding performance and reduce the leakage at the same time.
- The unique build-in ventilated plunger could expel the residual air automatically, then self-seal when touching with blood so that the blood sample could be sealed effectively.
- The special technique of heparin coating inside the syringe ensures the sufficient mixture of heparin and blood, providing more accurate result.
- The sealing cap design could seal the sampler completely, totally avoid test error caused by the mixed air, and provide better condition for sample's storage and transportation.

### Ordering information

Standard Type						
Catalogue No.	Syringe Volume (mL)	Recommended Fill Volume (mL)	Units of Heparin (IU)	Gauge	Needle Length (mm)	Applications
007-2232	3	1 (1.6 max.)	80	22G	32	Adult femoral artery
007-2225	3	1 (1.6 max.)	80	22G	25	Adult radial artery
007-2315	3	1 (1.6 max.)	80	23G	15	Children
007-2615	3	1 (1.6 max.)	80	26G	15	Infant
007-0000	3	1 (1.6 max.)	80	/	/	Without needle

### Safety Type

- Same syringe with standard type.
- Special structure makes the safety shield an integral part of the needle.
- Fully integrated shield offers enhanced safety for healthcare operators.
- Single-handed activation of the safety design provides simple and safe manipulation.
- After taking the blood sample, push or knock the shield gently to lock.
- The shield engages over the needle with an audible click and irreversibly locking, which avoids other people's injuries if the needle is exposed.

### Ordering information

Safety Type						
Catalogue No.	Syringe Volume (mL)	Recommended Fill Volume (mL)	Units of Heparin (IU)	Gauge	Needle Length (mm)	Applications
007-2232(S)	3	1 (1.6 max.)	80	22G	32	Adult femoral artery
007-2225(S)	3	1 (1.6 max.)	80	22G	25	Adult radial artery
007-2315(S)	3	1 (1.6 max.)	80	23G	15	Children
007-2615(S)	3	1 (1.6 max.)	80	26G	15	Infant

## Disposable Blood Pressure Transducer

CE



- Continuously auto-monitoring of the real-time hemodynamic changes guarantees the accurate measurement.
- Advanced CMOS chip provides superior sensitivity.
- Multiple types of popular connectors are suitable for most of the monitors in the market.

### Technical Parameters

Connector	Utah/Edwards/Abbot/BD/Philips/Crystal/Plate Connectors
Flush Speed	(3±1)ml/h/300mmHg
Pressure Measurement Range	-30~300mmHg
Sensitivity	5.0µv/v/mmHg ± 1%
Zero Drift	±10mmHg
Current Leakage	≤ 10µA
Marker	Artery-red / Vena-blue

### Ordering information

Catalogue No.	Channel Type	Catheter Length (cm)
MMBPTSA20	Single channel	20
MMBPTSA30	Single channel	30
MMBPTSB20	Double channel	20
MMBPTSB30	Double channel	30
MMBPTSC20	Triple channel	20
MMBPTSC30	Triple channel	30



# 08

## In Vitro Diagnostic Products



### IVD Equipment and Biomarkers

- 87 LEPU Quant 800 Colloidal Gold Immunochromatographic Assay Analyzer €€
- 87 Thrombelastography €€
- 88 Biomarkers €€



## LEPU Quant 800 Colloidal Gold Immuno-chromatographic Assay Analyzer

CE



### Fast

- Result is available in 15 minutes.

### Accurate

- Patent analyzing technology guarantees the accurate results.

### Convenient

- Whole blood can be used directly without centrifugation.
- Full set of diagnostic covers forecast, diagnosis and prognosis.
- 7" touch screen with great touch feeling and simple graphic interface.
- Built-in lithium battery and printer provide high movability for first aid and ambulance.
- Pocketable size makes it convenient to take along.
- Internal and external modes for different clinical needs.
- Available to connect with LIS/HIS for visual results.

### Applications

- Community Hospitals
- First Aid & Ambulance
- ICU/CCU
- Clinical Laboratory
- Department of Emergency
- Department of Cardiology
- Department of Respiration
- Department of Thoracic Surgery

### Suitable for patients with

- Symptoms of chest pain, stuffy or dyspnea
- High risk of cardiovascular disease
- Bacterial infection or sepsis

### Ordering Information

Catalogue No.	Quant 800
---------------	-----------

## Thrombelastography

CE



### Antiplatelet Drugs (1 test/box)

- Platelet Mapping Assay Kit – ADP pathway of platelet activation
- Platelet Mapping Assay Kit – ADP and AA pathways of platelet activation
- Platelet Mapping Assay Kit – AA pathway of platelet activation

### Heparin Residues (5 tests/box)

- Disposable Heparinase Cups and Assay Kits (method for determination of viscosity)

### The Whole Picture of the Blood Hemostasis Process (10 tests/box)

- Ordinary Cups and Assay Kits (method for determination of viscosity).
- Provide comprehensive whole blood hemostasis testing that can help to identify bleeding and thrombosis risks.
- Monitor anti-thrombotic therapies.
- Help doctors to identify the bleeding and thrombosis risks, and deliver more targeted treatments.
- Through usage of the Platelet Mapping Assay, the device can help to provide a picture ("tracing") of patients' potential response to antiplatelet therapy which is relative to their overall hemostasis.
- Two independent sample channels.

### Ordering Information

Catalogue No.	CFMS LEPU-8800
---------------	----------------



## Biomarkers

CE

- High stability, the accuracy is more than 98%.
- Whole blood can be applied directly without centrifugation.
- High purity antibody ensures the high specificity and sensitivity.
- Imported chromatographic membrane provides clear background with uniform chromatographic.
- Unique usage of h-FABP ensures the reliable result based on the outstanding specificity and earlier increased concentration.

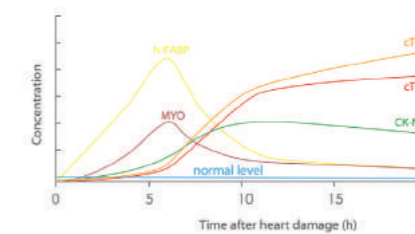

### Technical Parameters

Biomarker	Corresponding Disease	Inspection Scope	Testing Threshold
h-FABP	Myocardial Infarction	2.5-50ng/ml	7ng/ml
cTnI	Myocardial Infarction	0.5-50ng/ml	0.5ng/ml
cTnI/h-FABP	Myocardial Infarction	cTnI: 0.5-50ng/ml h-FABP: 2.5-50ng/ml	cTnI: 0.5ng/ml h-FABP: 7ng/ml
cTnI/Myo/CK-MB	Myocardial Infarction	cTnI: 0.5-50ng/ml Myo: 25-500ng/ml CK-MB: 2.5-300ng/ml	cTnI: 0.5ng/ml Myo: 50ng/ml CK-MB: 5ng/ml
NT-proBNP	Heart Failure	0.1-10ng/ml	Low: 0.3ng/ml High: 1.8ng/ml
D-Dimer	Thrombus	200-5000ng/ml	500ng/ml
MPO	Inflammation	25-500ng/ml	50ng/ml
CRP	Inflammation	0.5-100µg/ml	10µg/ml
PCT	Inflammation Bacterial Infection Sepsis	0.1-50ng/ml	0.25ng/ml

### Ordering Information

h-FABP quantitative cassette	NT-proBNP one step test cassette
cTnI quantitative cassette	D-Dimer one step test cassette
cTnI/h-FABP one step test cassette	MPO one step test cassette
cTnI/Myo/CK-MB one step test cassette	CRP quantitative cassette
	PCT quantitative cassette



# 09

## Digital Subtraction Angiography System

### Suspended Type

91 Vicor-CV300 Digital Subtraction Angiography System

### Floor Type

92 Vicor-CV100 Digital Subtraction Angiography System



## Vicor-CV300

### Digital Subtraction Angiography System



Vicor-CV300 provides all-electric control experience and comprehensive clinical applications to satisfy with multiple interventions in surgery and interventional radiology such as cardiovascular, neurovascular and peripheral vascular diagnosis and treatments.

- Ceiling-suspended structure with five degrees of freedom
- Advanced images chain configuration
- Imported X-ray tube
- High-resolution images

#### Three stages of protection ensure the safety of operation:

- Collision Detection System. The built-in 3D model simulator is able to monitor the status of the equipment to detect the distances of components, decelerating timely to avoid collision.
- Collision Brake System. Installed at the locations with high risk of collision. The system will automatically discontinue the movement to prevent damages.
- Movement Limitation Protection System. Each movement is protected by primary and secondary limitation protections to prevent over travel.

#### Movement Range:

The C-arm Opening Diameter: 1900mm

L-arm Rotating Range		-110°~110°
L-arm Longitudinal Movement		0~1900mm
L-arm at the Head End of Patient	LAO/RAO	135°/135°
	CRAN/CAUD	50°/90°
L-arm on the Right Side of Patient	LAO/RAO	90°/50°
	CRAN/CAUD	60°/60°
L-arm on the Left Side of Patient	LAO/RAO	50°/90°
	CRAN/CAUD	60°/60°
Source to Image-receptor Distance (SID)		850mm~1150mm
Catheter Bed		
Vertical Movement Range		725mm~1025mm
Longitudinal Movement Range		≥1200mm
Lateral Movement Range		-180mm~180mm

#### Ordering Information

Catalogue No.	Vicor-CV300
---------------	-------------

## Vicor-CV100

### Digital Subtraction Angiography System

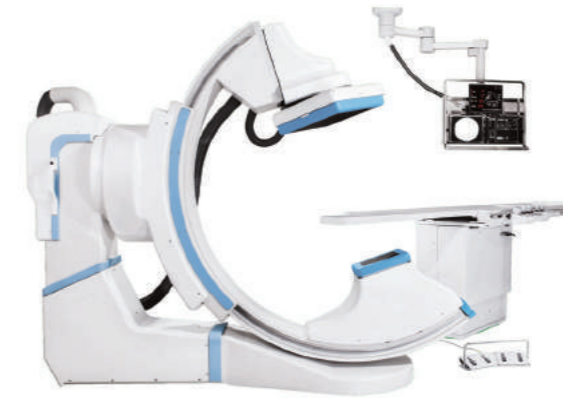

- Floor C Arm with multi-degree of freedom
- Varian digital flat panel detector
- Imported X-ray tube
- Advanced images chain configuration
- High-resolution images

#### Advanced digital imaging system:

- Super noise reduction filtration (SNRF): no damage to the image information; significantly increased signal to noise ratio (SNR) and decreased X-ray dosage for image capturing.
- Digital pattern recognition filtration (DPRF): intelligently recognized foreground image (contrast agent and interventional devices, etc.) for enhancement.
- Automatic density compensation filtration (ADCF): Automatic density equalization for background image to highlight the foreground image.

#### Three stages of protection ensure the safety of operation:

- Collision Detection System. The built-in 3D model simulator is able to monitor the status of the equipment to detect the distances of components, decelerating timely to avoid collision.
- Collision Brake System. Installed at the locations with high risk of collision. The system will automatically discontinue the movement to prevent damages.
- Movement Limitation Protection System. Each movement is protected by primary and secondary limitation protections to prevent over travel.

#### Movement Range:

L-arm Rotating Range		-90° ~ 90°
C-arm Movement Range	Longitudinal Rotating	-45° ~ 90°
	Transversal Rotating	-90° ~ 90°
Source to Image-receptor Distance (SID)		870mm ~ 1200mm
Catheter Bed		
Vertical Movement Range		780mm ~ 1100mm
Longitudinal Movement Range		≥ 1250mm
Lateral Movement Range		-150mm ~ 150mm

#### Ordering Information

Catalogue No.	Vicor-CV100
---------------	-------------

# 10

## General Surgery Products



### Surgical Staplers

- 95 Staplers CE
- 101 Disposable Skin Stapler and Remover CE
- 101 Disposable Purse String Stapler CE

### Accessories

- 102 Disposable Suction and Irrigation Tube CE
- 102 Disposable Trocar and Veress Needle CE
- 103 Disposable Endoscopic Retrieval Bags CE

## Staplers

CE

### Disposable Circular Stapler



- Ultrathin anvil is more convenient for the procedure.
- Larger inner cutting diameter effectively minimizes anastomosis stenosis.
- Rational arrangement of staples reduces bleeding after procedure.
- High-quality titanium staple guarantees greater tension-resistance on anastomosis.

#### Ordering Information

Catalogue No.	Protector Color	O.D. (mm)	Cutting Diameter (mm)	Staple Height (mm)	Quantity of Staples
DH14	Orange	14	8.5	3.8	20
DH17	White	17	10	4.5	16
DH19	Black	19	12	4.5	18
DH21	Yellow	21	14	4.5	20
DH24	Grey	24	15	4.5	18
DH26	Red	26	17	4.5	20
DH29	Blue	29	20	4.8	24
DH32	Green	32	22	5.0	26
DH34	Purple	34	24	5.0	28

### Disposable Double-hand Circular Stapler



- Ultrathin anvil and the scaled shaft make the procedure more convenient.
- Larger inner cutting diameter effectively minimizes anastomosis stenosis.
- Rational arrangement of staples reduces bleeding after procedure.
- Special safety design ensures the safe procedure.
- Butterfly-shape adjusting nut avoids slippery turning.

#### Ordering Information

Catalogue No.	Protector Color	O.D. (mm)	Cutting Diameter (mm)	Staple Height (mm)	Quantity of Staples
SGH14	Orange	14	8.5	3.8	20
SGH17	White	17	10	4.5	16
SGH19	Black	19	12	4.5	18
SGH21	Yellow	21	14	4.5	20
SGH24	Grey	24	15	4.5	18
SGH26	Red	26	17	5.0	20
SGH29	Blue	29	20	5.0	24
SGH32	Green	32	22	5.0	26
SGH34	Purple	34	24	5.0	28

### Disposable Auto Linear Stapler and Cartridge



- Middle closing stage helps to adjust the thickness of tissue.
- Large opening space allows of better tissue arrangement.
- Auto-adjusting tissue press is convenient for one-hand manipulation.

#### Ordering Information

Catalogue No.	Cartridge Model	Cartridge Color	Suture Thickness (mm)	Staple Height (mm)
CKH303	CH303	Blue	1.5	3.8
CKH304	CH304	Green	2.0	4.5
CKH453	CH453	Blue	1.5	3.8
CKH454	CH454	Green	2.0	4.5
CKH603	CH603	Blue	1.5	3.8
CKH604	CH604	Green	2.0	4.5
CKH903	CH903	Blue	1.5	3.8
CKH904	CH904	Green	2.0	4.5

### Disposable Double-hand Auto Linear Stapler and Cartridge



- Retaining pin avoids tissue over-flow.
- Automatic tissue clamping is easy for one-hand manipulation.
- Two triggers make it convenient for the operator and safe for the patient.

#### Ordering Information

Catalogue No.	Cartridge Model	Cartridge Color	Suture Thickness (mm)	Staple Height (mm)
SAF303	SF303	Blue	1.5	3.8
SAF304	SF304	Green	2.0	4.5
SAF453	SF453	Blue	1.5	3.8
SAF454	SF454	Green	2.0	4.5
SAF603	SF603	Blue	1.5	3.8
SAF604	SF604	Green	2.0	4.5
SAF903	SF903	Blue	1.5	3.8
SAF904	SF904	Green	2.0	4.5

### Disposable Linear Stapler and Cartridge



- Adjustable suture thickness
- Multiple sizes are available for different procedure requirements.

#### Ordering Information

Catalogue No.	Cartridge Model	Cartridge Color	Suture Thickness (mm)	Staple Height (mm)
HAF303	HF303	Blue	1.5	3.8
HAF304	HF304	Green	2.0	4.5
HAF453	HF453	Blue	1.5	3.8
HAF454	HF454	Green	2.0	4.5
HAF603	HF603	Blue	1.5	3.8
HAF604	HF604	Green	2.0	4.5
HAF903	HF903	Blue	1.5	3.8
HAF904	HF904	Green	2.0	4.5

### Disposable Linear Cutter and Cartridge



- Reloadable for ten times
- Accurate positioning function avoids tissue damage.
- Multiple sizes are available for different procedure requirements.

#### Ordering Information

Catalogue No.	Cartridge Model	Cartridge Color	Cutting Length (mm)	Suture Length (mm)	Suture Thickness (mm)	Staple Height (mm)
GH553	GK553	Blue	55	57	1.5	3.85
GH554	GK554	Green	55	57	2.0	4.5
GH753	GK753	Blue	75	77	1.5	3.85
GH754	GK754	Green	75	77	2.0	4.5
GH1003	GK1003	Blue	100	102	1.5	3.85
GH1004	GK1004	Green	100	102	2.0	4.5

### Disposable Linear Cutter and Linear Cutter Cartridge



- Scalpel on the cartridge avoids cross infection.
- Integration design of the blade and cartridge creates better cutting performance.
- Large opening space allows of better tissue arrangement.

#### Ordering Information

Catalogue No.	Cartridge Model	Cartridge Color	Cutting Length (mm)	Suture Length (mm)	Suture Thickness (mm)	Staple Height (mm)
QAB603	QB603	Blue	60	65	1.5	3.85
QAB604	QB604	Green	60	65	2.0	4.5
QAB803	QB803	Blue	80	85	1.5	3.85
QAB804	QB804	Green	80	85	2.0	4.5

### Disposable Curved Cutter Stapler



- Four curvilinear rows of staples with single cut contributes to the better performance.
- Lower pelvic access provides better procedure result.
- Simultaneous cutting and suturing simplify the resection of distal rectum.

#### Ordering Information

Catalogue No.	Suture Length (mm)	Staple Height (mm)	Quantity of Staples
QX45	48	4.5	46

### Disposable Hemorrhoids Stapler and Accessories



- Rational arrangement of staples reduces bleeding after procedure.
- Big volume of cartridge housing provides enough space for prolapsed tissue.
- Transparent anoscope with scales helps for better visibility.
- Adjustable cutting thickness allows of different prolapse situations.
- Non-slip adjusting nut provides better control.

#### Surgical Accessories:



Anorectal Introducer



Anorectal Dilator



Anorectal Transfixion Tool



Hook

#### Ordering Information

Catalogue No.	O.D. (mm)	Staple Height (mm)	Quantity of Staples
PAH32	32	3.8	30
PAH34	34	3.8	32
PAH36	36	3.8	34

### Disposable Endo Linear Cutter Stapler and Cartridge



#### Multiple choices for your requirements:

- Standard/short type of endocutter device
- Straight/rotatable type of cartridge
- Four staple heights are available

#### Scope of applications:

Suitable for tissue cutting under open surgery or endoscopic surgery include lungs, stomach, and intestines.

#### Contraindication:

Gastrointestinal submucosal edema, over thick muscular layer, poor healing capability, cancerous tissue residue.

#### Ordering Information

Catalogue No.		Cartridge Color	Staple Effective Length (mm)	Staple Height (mm)
Straight Type	Rotatable Type			
JQZ-30-2.5	JQD-30-2.5	White	30	2.5
JQZ-45-2.5	JQD-45-2.5	White	45	2.5
JQZ-45-3.5	JQD-45-3.5	Blue	45	3.5
JQZ-45-4.0	JQD-45-4.0	Golden	45	4.0
JQZ-45-4.8	JQD-45-4.8	Green	45	4.8
JQZ-60-2.5	JQD-60-2.5	White	60	2.5
JQZ-60-3.5	JQD-60-3.5	Blue	60	3.5
JQZ-60-4.0	JQD-60-4.0	Golden	60	4.0
JQZ-60-4.8	JQD-60-4.8	Green	60	4.8

## Disposable Skin Stapler and Remover

CE



Skin Stapler

Staple Remover

### Ordering Information

Catalogue No.	Cartridge Specifications (mm)	Staple Number	Staple Diameter (mm)	Staple Remover
PFW	7.0 × 4.5	15/25/35/45/55	0.6	PQW

## Disposable Purse String Stapler

CE



- Preloaded purse needle and string makes it easy for the operators.
- Free of manual operation for purse string helps to reduce the risk of damage on surrounding tissue.

### Ordering Information

Catalogue No.	Specification (mm)	Suture Length (mm)
CBHB-45	45	35
CBHB-65	65	56

## Disposable Suction and Irrigation Tube

CE



### Ordering Information

Catalogue No.	Cannula Diameter (mm)	Cannula Effective Length (mm)	Irrigation Tubing Length (mm)	Suction Tubing Length (mm)
BCX-330-II	5	330	600	2800
BCX-430-II	5	430	600	2800
BCX-330-III	5	330	2800	2800
BCX-430-III	5	430	2800	2800

## Disposable Trocar and Veress Needle

CE



Trocar



Veress Needle

### Ordering Information

Catalogue No.	Puncture Core Diameter (mm)	Puncture Core Length (mm)	Sheath I.D. (mm)	Sheath Length (mm)
BCW 5	5.5	200	5.8	100
BCW 10	10	200	10.5	100
BCW 11	11	200	11.4	100
BCW 12	12	200	12.8	100
BCW 13	13	200	13.5	100
BCW 15	15	200	15.6	100

Veress Needle Code No.	Needle Length (mm)	Needle O.D. (mm)	Needle I.D. (mm)
Y1	120	2.2	1.6
Y2	150	2.2	1.6

## Disposable Endoscopic Retrieval Bags

CE

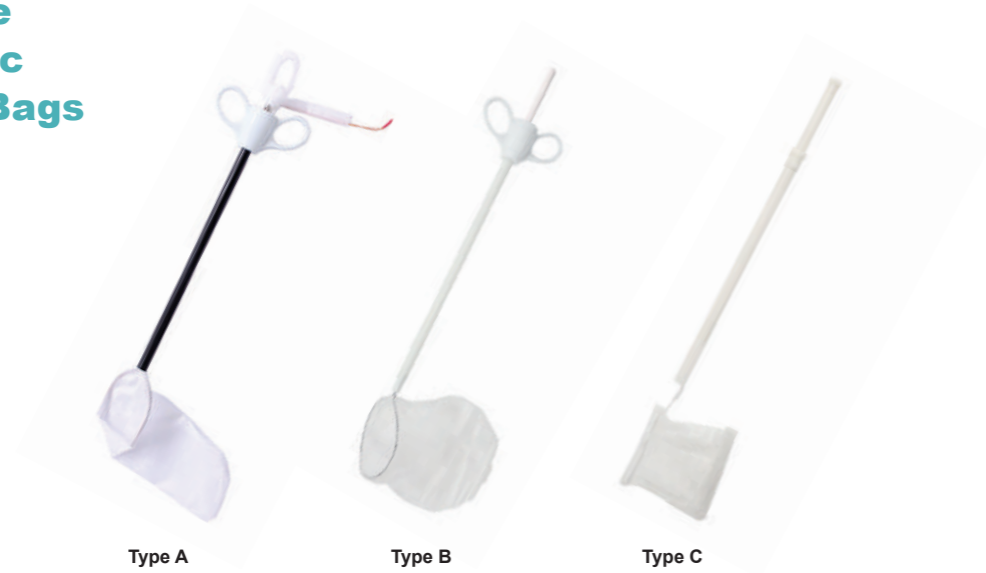

- Bag material of PU effectively prevent from osmosing of tissue fluid and remaining of tissue fragments during the procedure.
- Self-expanded bag makes it easy to collect the excision.
- “Up” marker on shaft indicates the direction of bag opening, which ensures safe operation.

### Ordering Information

Catalogue No.	Type	Flat Width (mm)	Flat Depth (mm)	Shaft O.D. (mm)
QD-A-1	A	80	100	10
QD-A-2	A	90	190	10
QD-A-3	A	100	100	10
QD-A-4	A	100	150	10
QD-A-5	A	120	200	10
QD-A-6	A	170	240	12
QD-A-7	A	200	260	15
QD-B-1	B	80	100	10
QD-B-2	B	90	190	10
QD-B-3	B	100	100	10
QD-B-4	B	100	150	10
QD-B-5	B	120	200	10
QD-B-6	B	170	240	10
QD-B-7	B	200	260	10
QD-C-1	C	80	100	10
QD-C-2	C	90	190	10
QD-C-3	C	100	100	10
QD-C-4	C	100	150	10
QD-C-5	C	110	200	10
QD-C-6	C	170	240	10
QD-C-7	C	200	260	10
QD-C-8	C	95	195	10
QD-C-9	C	130	195	10
QD-C-10	C	160	200	10

Notice: OEM is available for this product.